

# PRODUCT BULLETIN



---

Product: **Automatic Jammer / Injector**

---

Product Codes: **All FG053... Models**

---

Title: **HOW TO CONNECT & DISCONNECT THE POWER SUPPLY**

---



# Correct Procedures for Connecting & Disconnecting the Mains Power Supply if Kycon Snap & Lock Connector Fitted

It has been brought to our attention that some customers who have a Kycon Snap & Lock connector fitted to the Power Supply of their MONO Automatic Jammer / Injector are not aware the connection is actually a two-step process.

If your Automatic Jammer / Injector is fitted with this type of connector, it is imperative that the procedures detailed below are followed; failure to do so may cause electrical issues resulting in damage to the Power Supply and Power Socket Assembly which may invalidate the product's Warranty.

## The Kycon Snap & Lock Connector:



Connecting the Power Supply Lead to the back of the Auto Jammer / Injector Base Unit requires a two-step process to ensure the power lead is connected correctly, safely and securely.

Please follow the instruction detailed below when connecting and disconnecting your Unit's Power Supply; this will help prolong the life of your Auto Jammer / Injector.

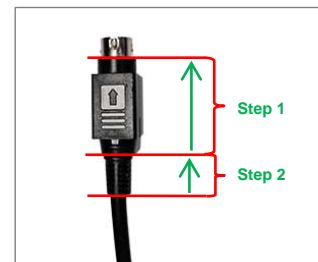

## Connecting the Kycon Power Supply to the Base Unit:



**FIRSTLY:**  
ALWAYS ensure the **flat side** of the connector, with the arrow symbol, is facing to the **left**, when connecting the power supply.



**STEP 1:**  
Holding the flat side of the connector between finger and thumb, push until the silver part of the connector is no longer visible.

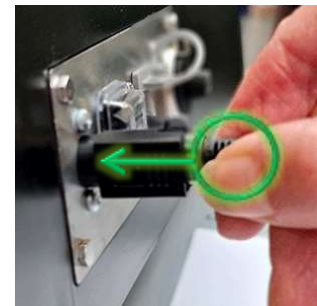

**STEP 2:**  
Grip the power lead immediately behind the flat area of the connector and push forwards until you feel / hear a click.

## Disconnecting the Kycon Power Supply from the Base Unit:



**ALWAYS:**  
Grip the flat area of the connector between thumb and finger and pull gently to remove the power supply.

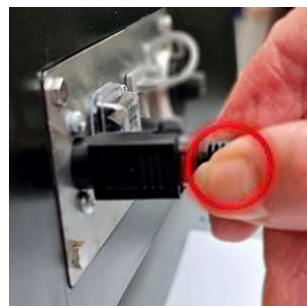

**NEVER:**  
Grip the power lead behind the main part of the connector and pull – this may damage the power supply lead.