



[www.monoequip.com](http://www.monoequip.com)



# AZTEC

## DONUT FRYER PLC VERSION

### SPARES MANUAL

### MACHINE NO.FG059

When ordering spares please quote the **machine serial number** which can be found on the silver information plate of the machine and on the front cover of your manual.

**MONO EQUIPMENT**  
**Queensway**  
**Swansea West Industrial Estate**  
**Swansea. SA5 4EB UK**

Tel. +44(0)1792 561234  
**email:spares@monoequip.com**  
**Spares Tel. +44(0)1792 564039**  
Fax. 01792 561016

## **SAFETY SYMBOLS**

The following safety symbols are used throughout available product documentation and the operating manual (available at [www.monoequip.com](http://www.monoequip.com)).

Pay special attention to information marked with the following symbols.



### **WARNING**

Indicates a hazardous situation which, if not avoided, will result in death or serious injury.



### **WARNING**

Indicates a hazardous situation which, if not avoided, will result in electric shock.



### **CAUTION**

Indicates a hazardous situation which, if not avoided, will result in minor or moderate injury.

## **ELECTRICAL SAFETY AND ADVICE REGARDING SUPPLEMENTARY ELECTRICAL PROTECTION:**

Commercial bakeries, kitchens and foodservice areas are environments where electrical appliances may be located close to liquids or operate in and around damp conditions or where restricted movement for installation and service is evident.

The installation and periodic inspection of the appliance should only be undertaken by a qualified, skilled and competent electrician, and connected to the correct power supply suitable for the load as stipulated by the appliance data label.

The electrical installation and connections should meet the necessary requirements of the local electrical wiring regulations and any electrical safety guidelines.

### **No work should be undertaken without disconnecting the power.**

### **We Recommend:**

- Supplementary electrical protection with the use of a residual current device (RCD)
- Fixed wiring appliances incorporate a locally situated switch disconnecter to connect to, which is easily accessible for switching off and safe isolation purposes. The switch disconnecter must meet the specification requirements of IEC 60947.



The supply to this machine must be protected by a **30mA RCD**

# **AZTEC FRYER SPARES**

	PAGE
<b>MAIN COMPONENT PARTS LAYOUT</b>	- 4
<b>ELECTRICAL BOX PARTS LAYOUT</b>	- 5
ELECTRICAL BOX PART NUMBERS	- 6
<b>CARRIER LIFT DRIVE PARTS</b>	- 7
<b>FILTER SYSTEM PARTS</b>	- 8
PUMP AND FITTINGS	- 9
PUMP CONNECTIONS AND TAP FITTINGS	- 10
<b>ELEMENT BOX PARTS</b>	- 11
<b>CARRIER/TURNOVER PARTS</b>	- 12

# MAIN COMPONENTS PARTS

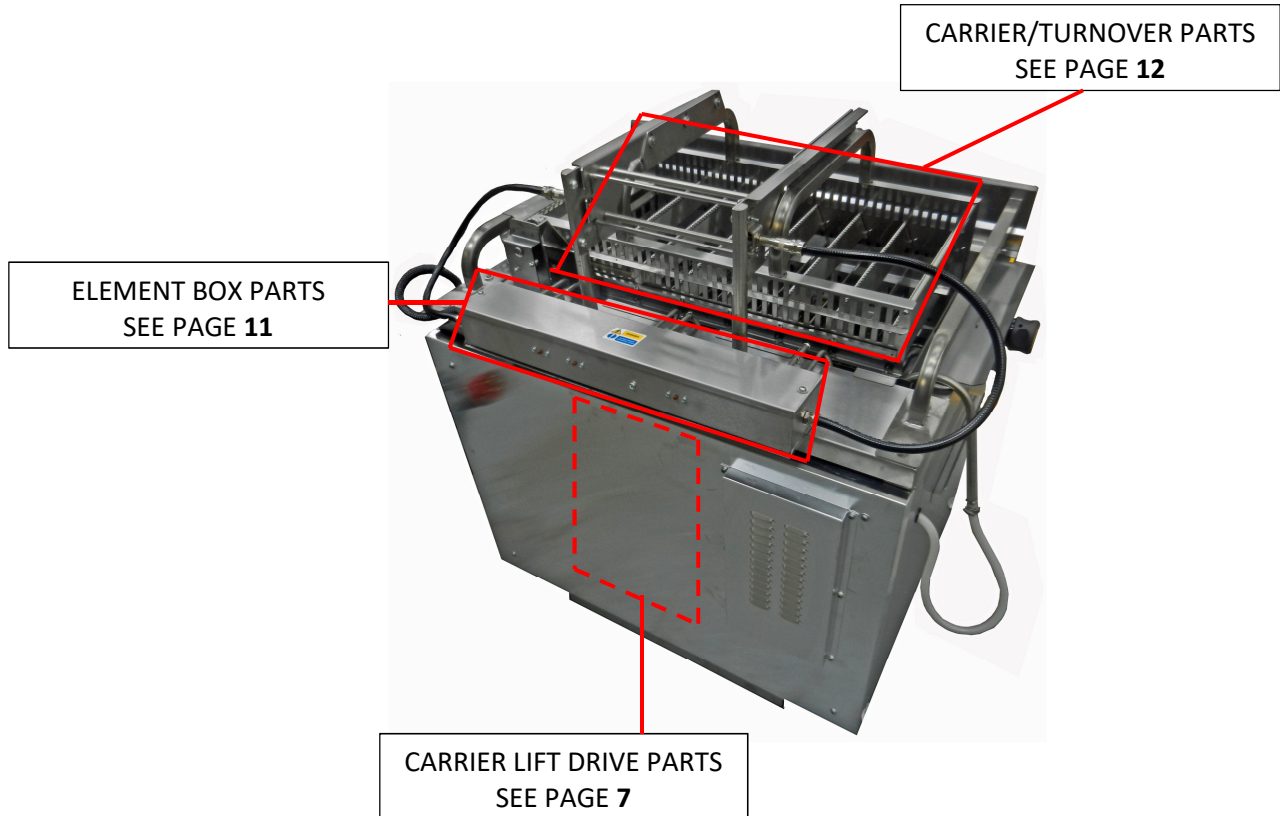
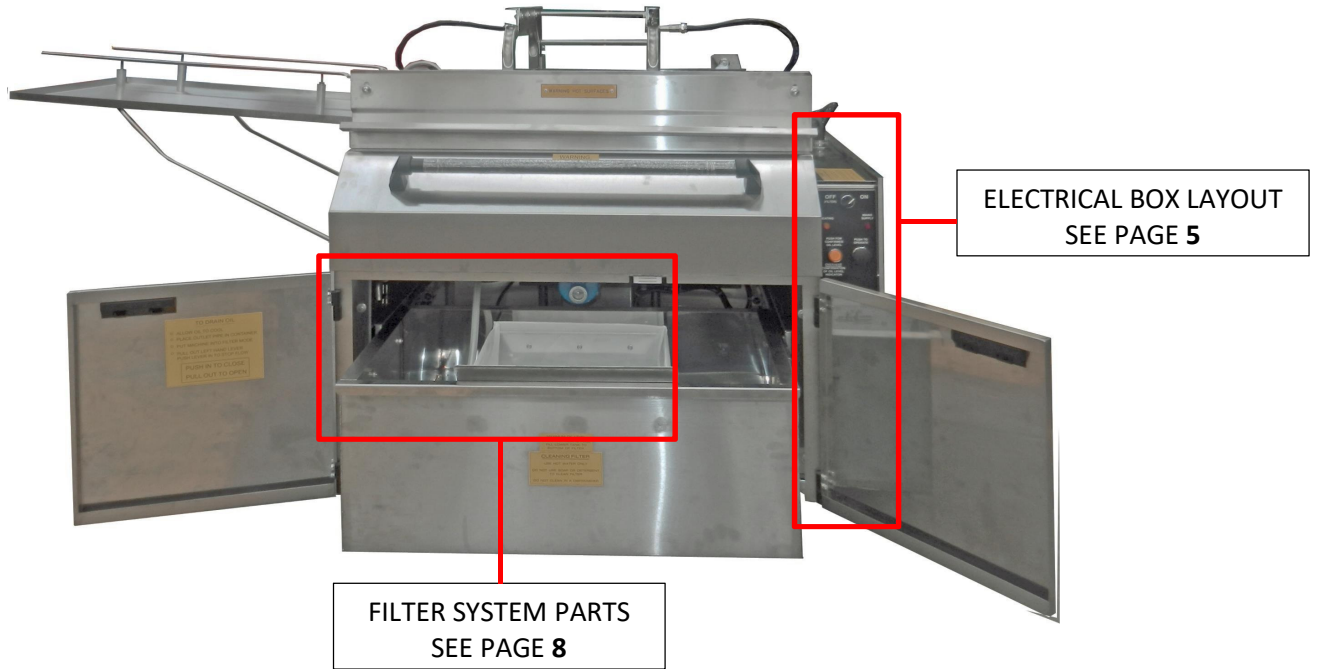

# ELECTRICAL BOX PARTS LAYOUT

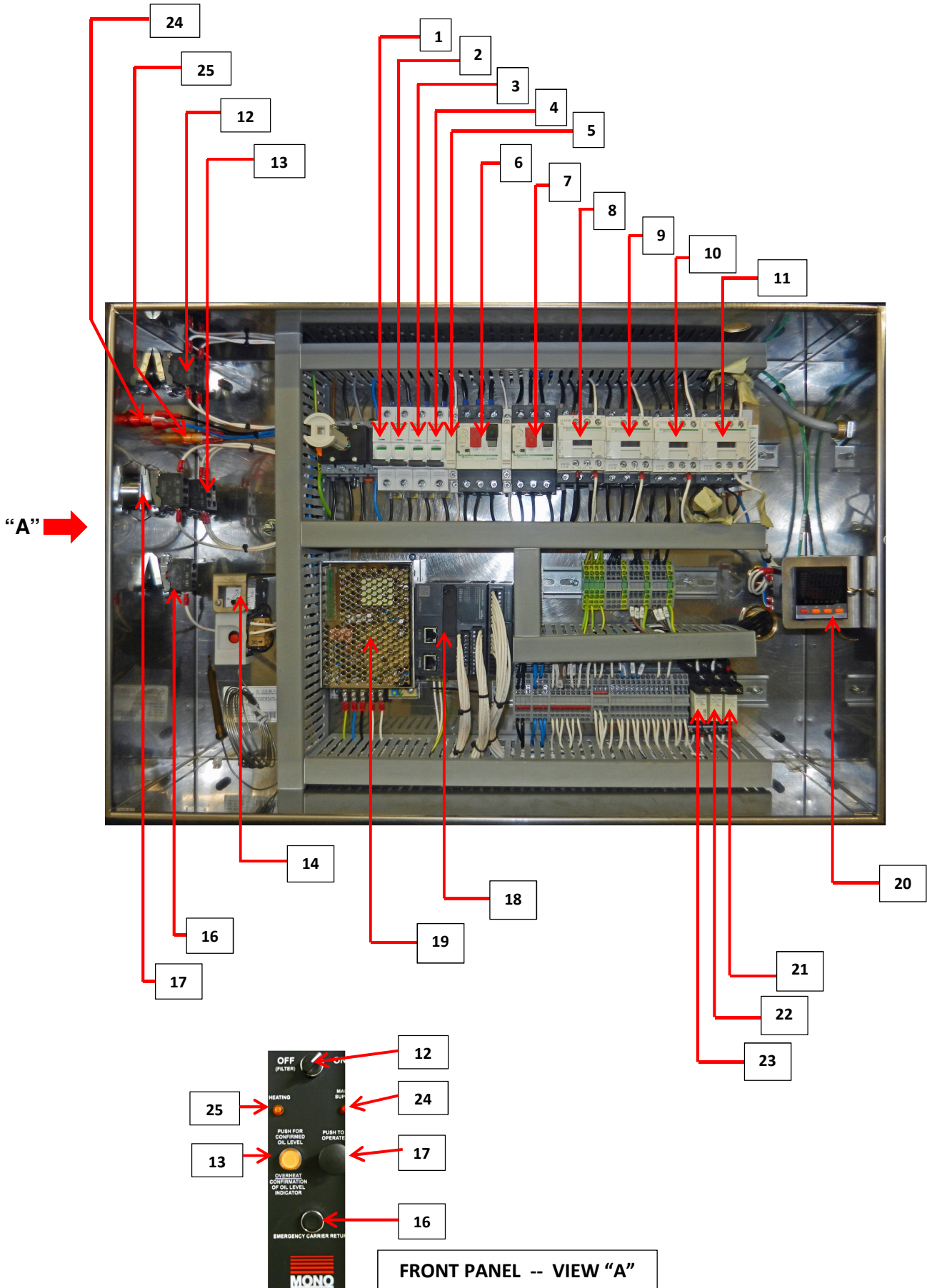

# ELECTRICAL BOX PART NUMBERS

---

ITEM	PART NUMBER	DESCRIPTION	QTY
1	B872-22-062	CONTROL MCB	1
2	B872-22-008	HEATING MCB	1
3	B872-22-008	HEATING MCB	1
4	B872-22-008	HEATING MCB	1
5	B801-14-012	AUX CONTACT BLOCK	1
6	B801-03-018	PUMP MOTOR STARTER	1
7	B801-03-020	MAIN MOTOR STARTER	1
8	B801-08-021	HEATING ELEMENT CONTACTOR	1
9	B801-08-031	PUMP CONTACTOR	1
10	B801-08-031	CARRIER MOTOR UP CONTACTOR	1
11	B801-08-031	CARRIER MOTOR DOWN CONTACTOR	1
12	WAITING ELECTRICAL DEPT CONFIRMATION		
13	WAITING ELECTRICAL DEPT CONFIRMATION		
14	B873-30-001	OVERHEAT THERMOSTAT	1
16	WAITING ELECTRICAL DEPT CONFIRMATION		
17	WAITING ELECTRICAL DEPT CONFIRMATION		
18	WAITING ELECTRICAL DEPT CONFIRMATION		
19	B801-93-005	POWER SUPPLY	1
20	B817-91-002	TEMPERATURE CONTROLLER	1
21	B801-37-001	VALVE OPEN RELAY	1
22	B801-37-001	VALVE CLOSE RELAY	1
23	B801-37-001	BUZZER RELAY	1
24	B842-43-001	RED INDICATOR LIGHT	1
25	B842-43-002	AMBER INDICATOR LIGHT	1

# CARRIER LIFT DRIVE PARTS

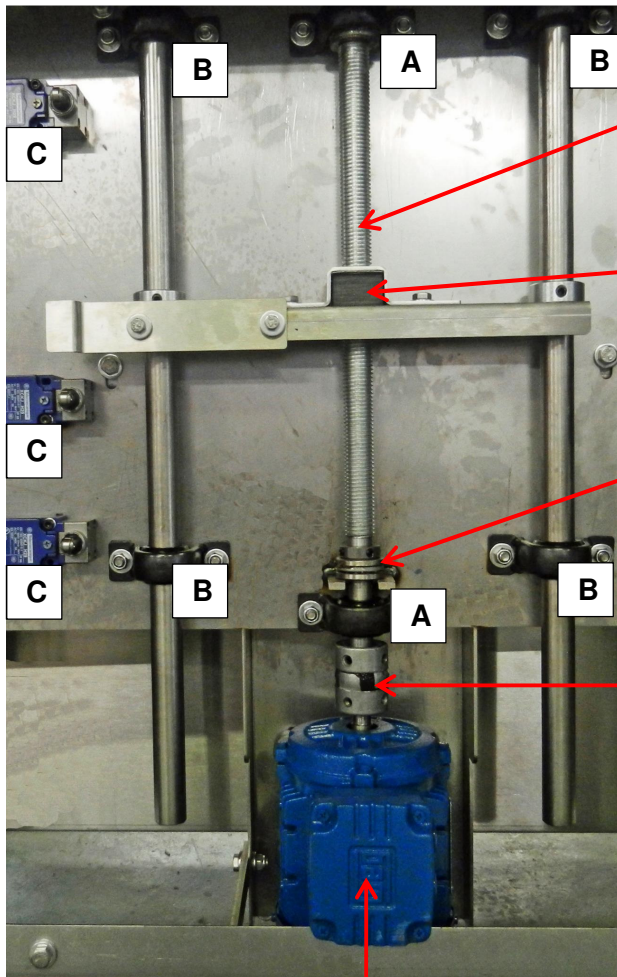

DRIVESHAFT AND NUT (MATCHED)  
029-18-03400

SCREW NUT ONLY  
029-18-03700

THRUST BEARING  
A900-06-016

FLEXIBLE COUPLING  
029-04-03000

MOTOR  
B859-74-033

**A** BEARING  
P700-05-021  
HOUSING  
A900-06-185

**B** BEARING  
P700-05-022  
HOUSING  
A900-06-185

**C** LIMIT SWITCH  
B801-11-013  
OPERATING HEAD  
B801-45-005

# FILTER SYSTEM PARTS

## DRAIN TANK PARTS

SILICONE HOSE, 350MM LONG  
A900-23-034

POWERED BALL VALVE  
A900-34-389

FILTER BAG  
A900-30-018

BRAIDED HOSE, 550MM LONG  
A900-23-026

RUNNER WHEEL  
A900-20-038

MESH FILTER  
A900-34-305

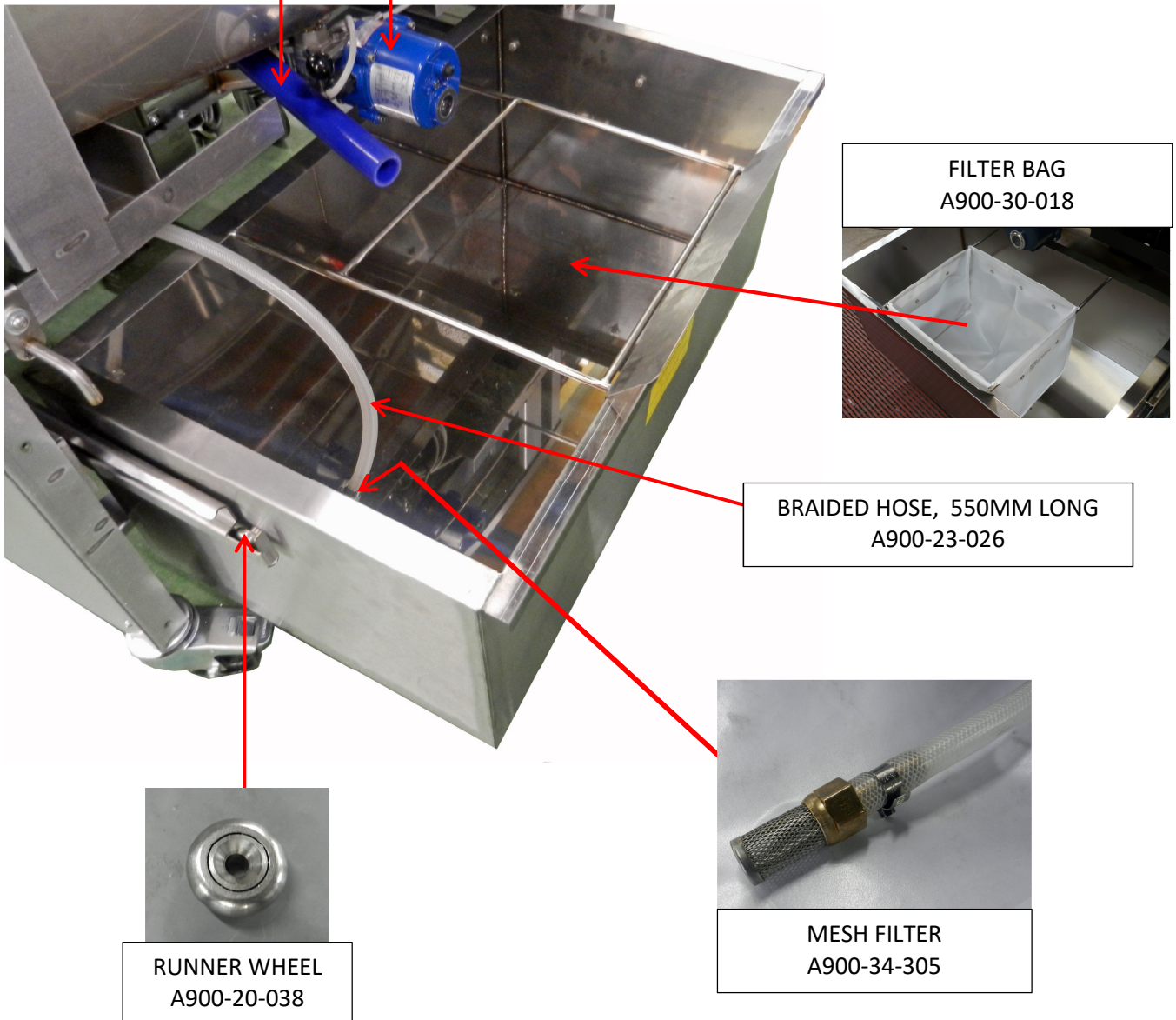



# PUMP AND FITTINGS

CONNECTIONS FITTING LIST ON NEXT PAGE

3-WAY BALL VALVE  
A900-34-135

STAINLESS STEEL CONVOLUTED HOSE  
029-19-02100

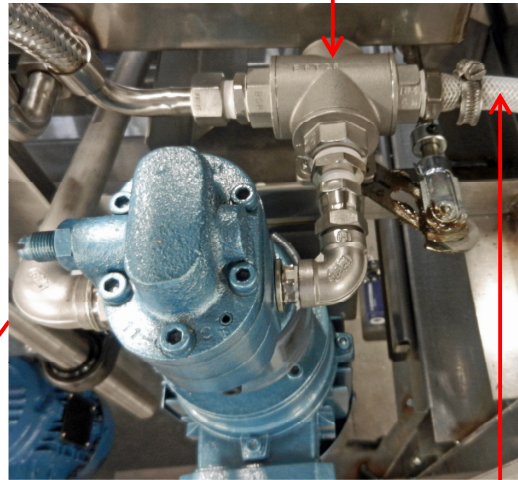
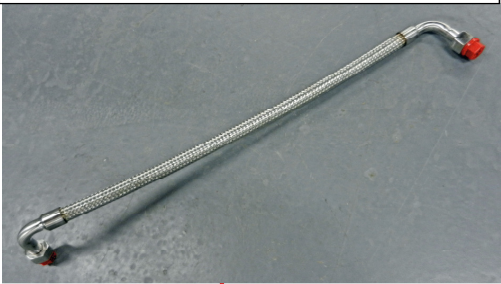

REAR VIEW

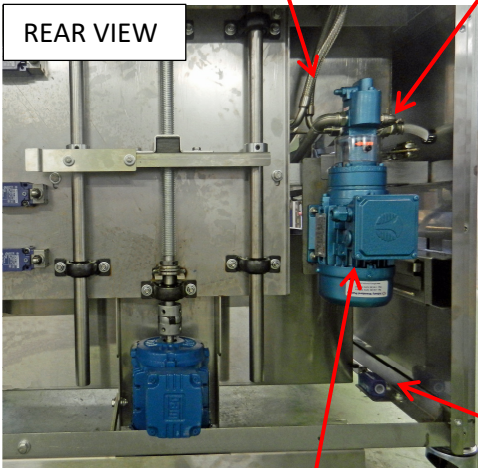

SWITCH BRACKET  
029-19-00900

LIMIT SWITCH  
B801-11-014



BRAIDED HOSE, 750MM LONG  
A900-23-026

PUMP (FOR PLC VERSION)  
B754-74-003

OUTLET HOOK  
029-19-00800

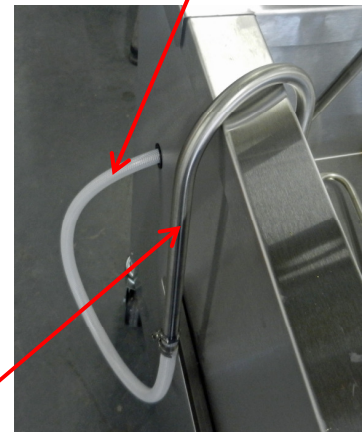

# PUMP CONNECTION AND TAP CONTROL FITTINGS

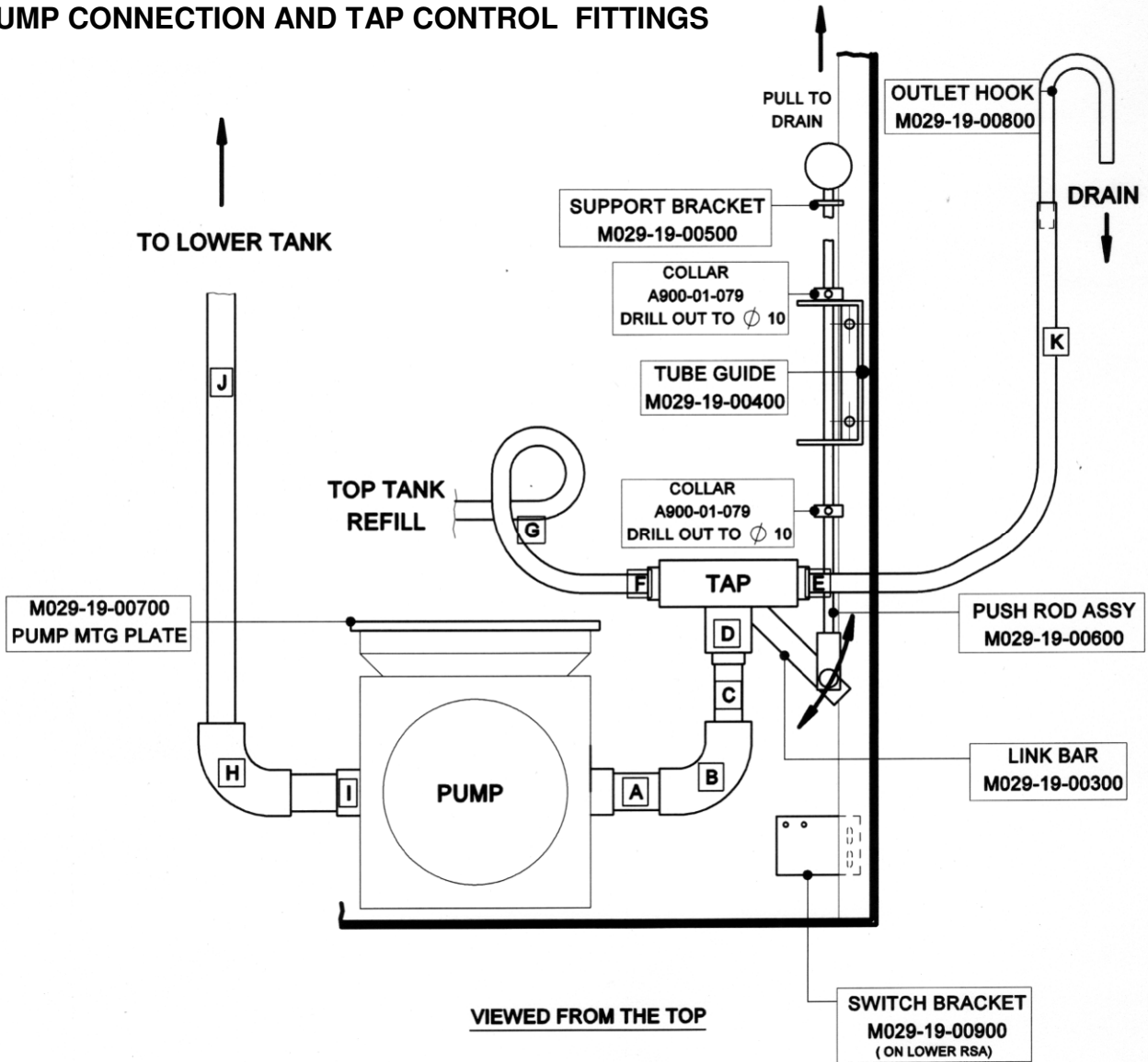

- A** A900-34-291 1/4BSP X 1/4BSPT + COPPER WASHER
- B** A900-34-290 1/4BSP X 1/4BSP ELBOW
- C** A900-34-246 1/4M X 1/4F
- D** A900-34-247 1/4M X 1/2TM
- E** A900-34-292 1/2BSPT X 3/8 BARB
- F** A900-34-248 1/2 BSPT X 3/8 MALE NIPPLE
- G** 029-19-02100 METALLIC CONVOLUTED HYDRAULIC HOSE
- H** A900-23-031 3/8 ELBOW
- I** A900-23-030 1/4BSP X 3/8BSPT + COPPER WASHER
- J** M029-19-05900 3/8BSPT X 450 LG
- K** A900-23-032 FLEX TUBING

# ELEMENT BOX PARTS

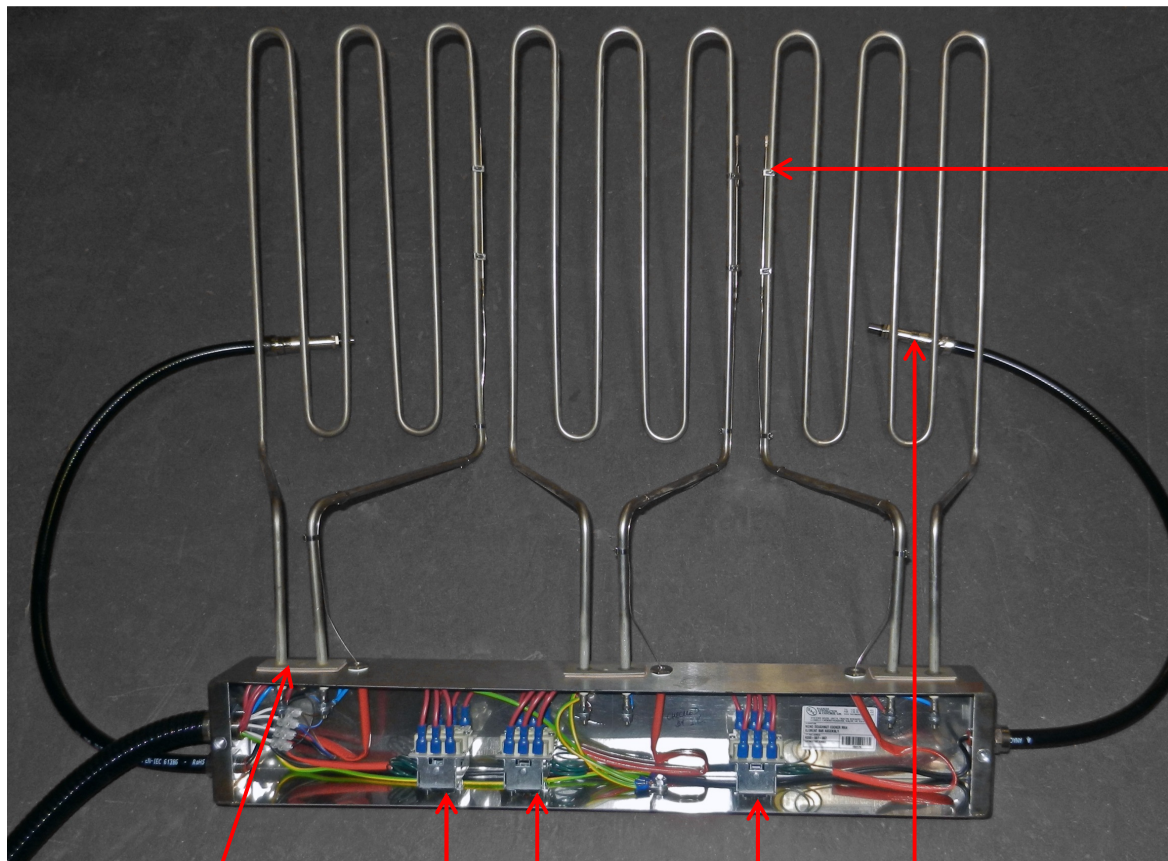

ELEMENTS  
B906-04-001

TEMP STATS  
B888-30-015

CARRIER SENSOR  
B801-99-015

STAINLESS STEEL  
CABLE TIE  
B842-62-020



ELEMENT BOX LID  
029-25-36100

# CARRIER/TURNOVER PARTS

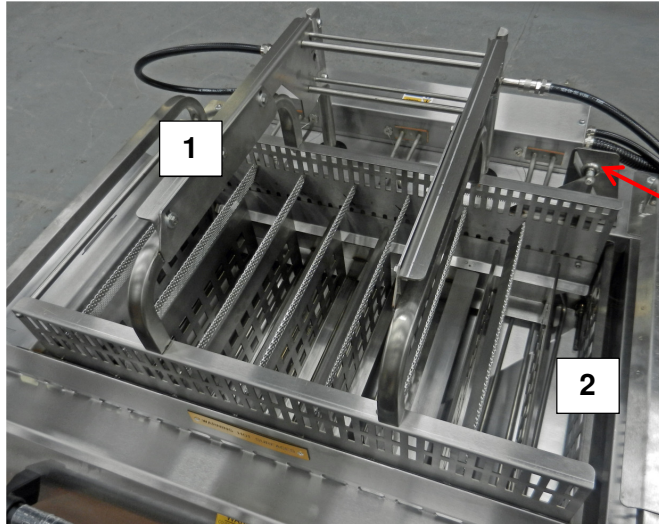

WHEEL  
A900-20-038

1	A 3D perspective rendering of a metal turnover device assembly, showing a rectangular frame with internal bars and a hinged mechanism.	<p>7-LANE TURNOVER DEVICE ASSEMBLY 059-19-00000</p> <p>8-LANE TURNOVER DEVICE ASSEMBLY 029-18-00000</p>
2	A 3D perspective rendering of a metal splitter unit, which is a rectangular tray with a perforated metal surface and a hinged front edge.	<p>7-LANE SPLITTER UNIT 059-19-00000</p> <p>8-LANE SPLITTER UNIT 029-15-00000</p>