



AC Conical rounder

The AC conical rounder is used to round portions of dough and prepare them for the subsequent operations. Dividing the dough, both manually and mechanically, causes the fibres to break along the cutting line. The intermediate rounding operation ""closes"" the portions, giving them a spherical form and, by recomposing the fibres, promotes uniform slackening of the dough, enhancing its workability. The conical rounder can be fed in line by SP and DVD volumetric dividers. The machine outlet is normally coupled to FE long moulders or ECP intermediate provers.

Features

- Steel structure mounted on wheels.
- Outer casing painted with dual cycle anti-corrosion treatment using epoxy powders (food contact).
- Natural aluminum cast
- Natural aluminum cast rotating cone with vertical grooving
- Teflon-coated aluminium feed channels.
- Belt transmission system that guarantees reliability and quiet operation.
- Mechanical flour duster.
- Electrical power supply: V. 400/3/50Hz (different voltages on request).

Option:

- TFL— Teflon-coated cone for sticky and slack dough
- CNL—smooth cone, without grooves (facilitate pastry dough processing)
- INR— reticular grooving cone (facilitate the dry dough processing)

Accessories

- A: Hot air-blower to facilitate the processing of particularly slack and sticky dough.
- U: Powered exit belt planned for coupling the conical rounder to other machines, especially to FE long moulders. Its application excludes the possibility to install the CF long moulding device.
- CF: Long moulding device mounted on the conical rounder structure including an adjustable pressing device suitable for the production of loaves max. 450 mm. long. Its application excludes the possibility to install the powered exit belt mod. U.

This machine complies  regulations.

MODEL	Description
AC/01	Conical rounder - Approx. dough piece weight from gr. 60/80 to gr. 300/400
AC/1	Conical rounder - Approx. dough piece weight from gr. 200 to gr. 1200
AC/3	Conical rounder - Approx. dough piece weight from gr. 400 to gr. 2300
AC/4	Conical rounder - Approx. dough piece weight from gr. 800/1000 to gr. 3000

OPTIONS

Model	Description
A	Option: hot air blower
U	Option: powered exit belt
CF	Option: long moulder with adjustable pressing device
RV	Option: vertical marks on cone instead of reticular marks (see drawing and table)
TFL	Option: teflonated cone
CNL	Option: smooth cone
INR	Option: reticular marks cone



Conical rounder with "A"
hot air blower



Conical rounder with "U"
powered exit belt



Conical rounder with "CF"
long moulding device

ARROTONDATRICE CONICA – AC

NOR08M001_01

CONICAL ROUNDER – AC

09/07/09

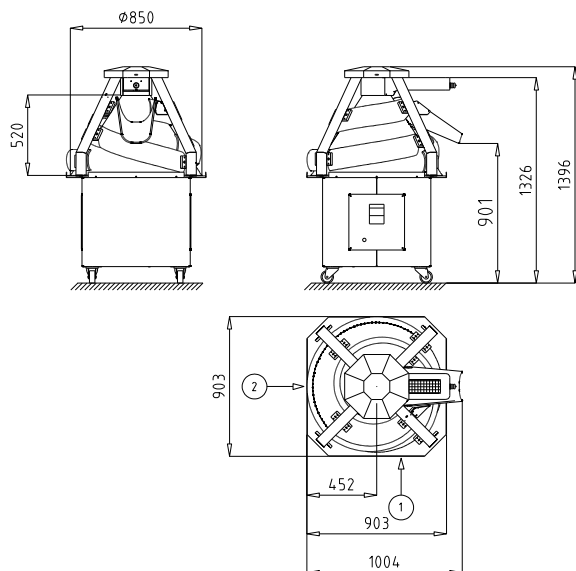

AC-AC/P con tappeto uscita "U"

AC-AC/P with conveyor belt "U"

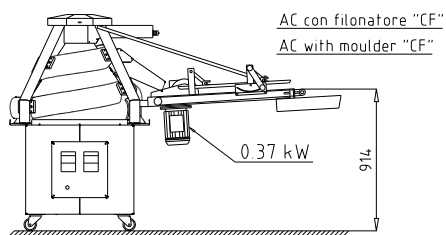
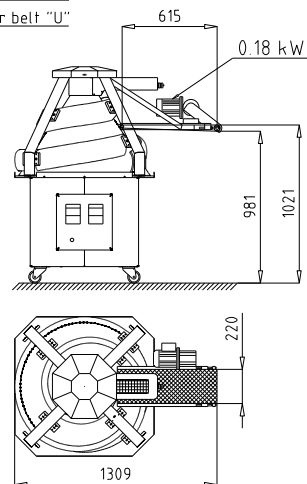

AC con filonatore "CF"

AC with moulder "CF"

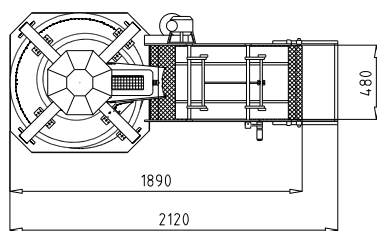

RIGATURE SU CONO - MARKS ON CONE

TIPO STANDARD (C)
TYPE STANDARD (C)



RIGATURE ALTERNATIVE SU CONO - ALTERNATIVE MARKS ON CONE

TIPO - TYPE A
LISCIO - SMOOTH



TIPO - TYPE D

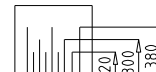

TIPO - TYPE D



TIPO A QUADRI
TYPE SQUARE

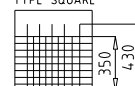

DATI TECNICI – TECHNICAL FEATURES	AC	01	1	3	4
PEZZATURE MIN/MAX – MIN/MAX SIZES	g	60/80–300/400	200–1200	400–2300	800/1000–3000
POTENZA INSTALLATA – INSTALLED POWER	kW	0.75	0.75	1.1	1.1
PESO – WEIGHT	kg	345	345	345	345
CONNESSIONE ELETTRICA – PLUG COUPLING		3PH+Gr	3PH+Gr	3PH+Gr	3PH+Gr
GRUPPO ARIA CALDA "A" / WARM AIR GROUP "A"					
VENTILATORE – FAN	kW	0.18	0.18	0.18	0.18
Resistenza – Resistance	kW	0.50	0.50	0.50	0.50

① ② Lati carico da terra H=850
Side of loading, height=850

N.B.: I modelli di conica AC/0 e AC/01 si possono caricare solo al punto ①
The models AC/0 and AC/01 can be loaded on position ① only.

Scala 1:20