



www.monoequip.com

Enter **Serial No.** here. _____

In the event of an enquiry please quote this serial number.



SET UP, OPERATION AND PROGRAMMING INSTRUCTIONS

MX ROTARY RACK OVEN

ELECTRIC VERSION

STANDARD 45kW

LOW POWER 36kW

INCREASED SIZE 60 x 80 tray, 56kW

ECOTOUCH CONTROL

FILE 141



DECLARATION OF CONFORMITY

We hereby declare that this machine complies with the essential health and safety requirements of :-

- The Machinery Directive 2006 / 42 / EC
- The Low voltage Directive 2014 / 35/ EC
- The requirements of the Electromagnetic Compatibility Directive 2004 / 108EC, 91 / 263 / EEC, 92 / 31 / EEC
Incorporating standards
EN55014-1:2006+A1:2009+A2:2011
EN55014-2:1997+A1:2001+A2:2008
- The General Safety of Machinery and food processing Standards applicable
- Materials and Articles intended to come into contact with food Regulation (EC) No. 1935 / 2004

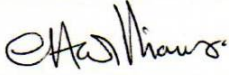
Signed	
G.A.Williams – Quality Manager	

Date	
-------------	--

Machine FG Code.		Machine Serial No.	
-------------------------	--	---------------------------	--

A technical construction file for this machine is retained at the following address:

MONO EQUIPMENT
Queensway,
Swansea West Industrial Park,
Swansea
SA5 4EB
UK

MONO EQUIPMENT is a business name of **AFE GROUP Ltd**
Registered in England No.3872673 VAT registration No.923428136

Registered office: Unit 9, Bryggen Road,
North Lynn Industrial Estate,
Kings Lynn,
Norfolk,
PE30 2HZ

SAFETY SYMBOLS

The following safety symbols are used throughout this product documentation and manual (available at www.monoequip.com).

Before using your new equipment, read the instruction manual carefully and pay special attention to information marked with the following symbols.



WARNING

Indicates a hazardous situation which, if not avoided, will result in death or serious injury.



WARNING

Indicates a hazardous situation which, if not avoided, will result in electric shock.



CAUTION

Indicates a hazardous situation which, if not avoided, will result in minor or moderate injury.



ELECTRICAL SAFETY AND ADVICE REGARDING SUPPLEMENTARY ELECTRICAL PROTECTION

Commercial bakeries, kitchens and food service areas are environments where electrical appliances may be located close to liquids, or operate in and around damp conditions, or where restricted movement for installation and service is evident.

The installation and periodic inspection of the appliance should only be undertaken by a qualified, skilled and competent electrician, and connected to the correct supply suitable for the load as stipulated by the appliance data label.

The electrical installation and connections should meet the necessary requirements of the local electrical wiring regulations and any electrical safety guidelines.

We Recommend:

- Supplementary electrical protection with the use of a residual current device (RCD)
- Fixed wiring appliances incorporate a locally situated switch disconnector to connect to, which is easily accessible for switching off and safe isolation purposes. The switch disconnector must meet the specification requirements of IEC 60947.

Your attention is drawn to:

BS 7671:2018 – Guidance Note 8 – 8.13 : Other locations of increased risk

It is recognised that there may be locations of increased risk of electrical shock other than those specifically addressed in Part 7 of BS 7671. Examples of such locations could include laundries where there are washing and drying machines in close proximity, and water is present, and commercial kitchens with stainless steel units, where once again, water is present. Where, because of the perception of additional risks being likely, the installation designer decides that an installation or location warrants further protective measures, the options available includes:

- Automatic Disconnection of Supply (ADS) by means of a residual current device having a residual operating current not exceeding 30 mA;
- Supplementary protective equipotential bonding; and
- Reduction of maximum fault clearance time.

The provision of RCDs and supplementary bonding must be specified by the host organisation's appointed installation designer or electrical contractor and installed by a suitably qualified and competent electrician so as to comply with Regulations 419.2 and 544.2.



The supply to this machine must be protected by a **30mA RCD**

CONTENTS

	PAGE	
Section - 1	Introduction	7
Section - 2	Overall Dimensions	8
Section - 3	Specifications	9
Section - 4	Safety	11
Section - 5	Installation	13
Section - 6	Isolation	14
Section - 7	Cleaning Instructions	17
Section - 8	General Maintenance Instructions	18
Section - 9	Operation	19
	9- 1.0 baking using favourites	21
	9- 2.0 baking using manual menu	24
	9- 3.0 baking using programmes	27
	9- 4.0 creating a program	30
	9- 5.0 setting 7-day timer	36
	9- 6.0 settings	37
	9- 7.0 using usb port/stick	44
	9- 8.0 diagnostics	47
Section - 10	Troubleshooting	48
	Setting air slots	49
Section – 11	Spares and Services	50
Section - 12	Electrical information	51
Section - 13	Spares	59

NOTE

All reference to RIGHT HAND ovens means that the main door is hinged on the right and the control panel is on the left.



RIGHT HAND

All reference to LEFT HAND ovens means that the main door is hinged on the left and the control panel is on the left.

1.0 INTRODUCTION

The **MONO MX** rotary rack oven is a compact, electrically heated oven with a touchscreen control panel. The standard version of the MXTE oven accommodates a single **rotating rack** of up to eighteen trays capacity. Versions of the MXTE oven with a rack turntable option support a **standard rack**.

Eco-touch ovens are factory-fitted with touchscreen control panels. This user-friendly controller shows pictures of product types or program numbers as set by the user. When not being used, the screen can show your company logo.

A voice-prompt facility is also available for the basic instructions like "Bake over."



ECOTOUCH SCREEN CONTROLS



The stainless steel construction of the oven has easily cleaned interior and exterior surfaces and a bright appearance. The fan and rack rotator have generously rated, totally enclosed motors and a sealed-for-life gearbox.

The high-speed fan, heating, and steam systems give efficient air circulation to produce a professional bake across a range of products via a diagonal cross-flow system with efficient air circulation. The steam system is connected to a standard water supply. (Pumps are available for very low-pressure areas).

Steam is generated within the oven chamber by means of a multi-point, water injection cascade. The amount of steam to be generated is controlled by means of a programmable time period on the control panel. No drain is required for the baking and steaming process of this oven.

Programmed damper control is provided as part of the programming controls.

The oven door incorporates a large glass panel and LED lights to afford an excellent view of the baking progress. To optimise a bakery layout, the main oven door can be hinged on either side even if the oven is relocated after initial installation.

2.0 OVERALL DIMENSIONS

STANDARD VERSION

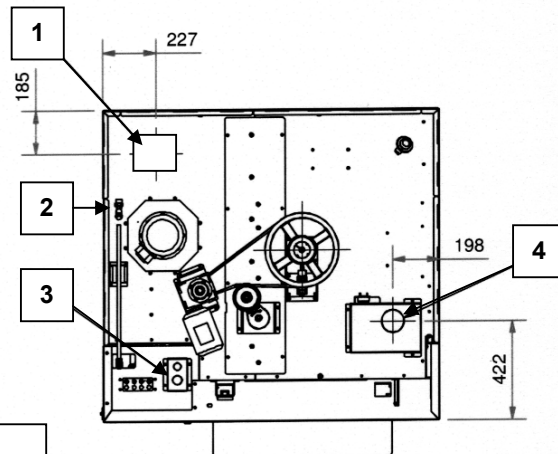
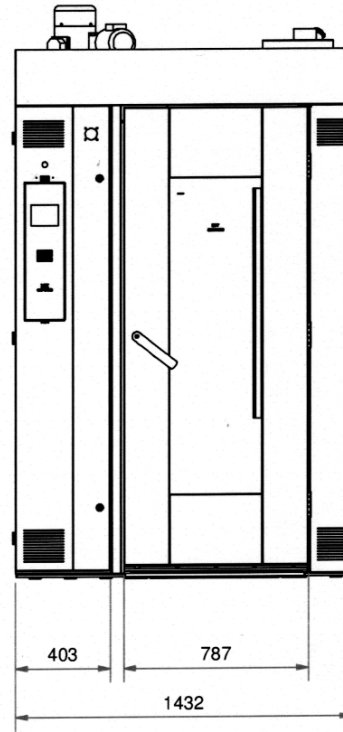
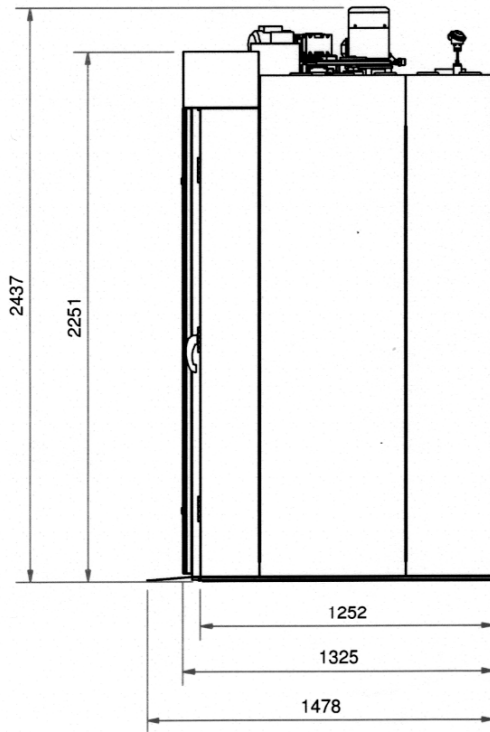

- 1. FLUE GAS CONNECTION
(BLANK PLATE ON ELECTRIC OVENS)
 - 2. WATER CONNECTION: 3/4" BSP
 - 3. POWER CABLE INLET
 - 4. STEAM DIVERTER BOX CONNECTION 10mm DIA.
- MAX. RACK DIAGONAL = 885mm
DOOR SWING RADIUS = 790mm

LARGER 60 X 80 TRAY VERSION

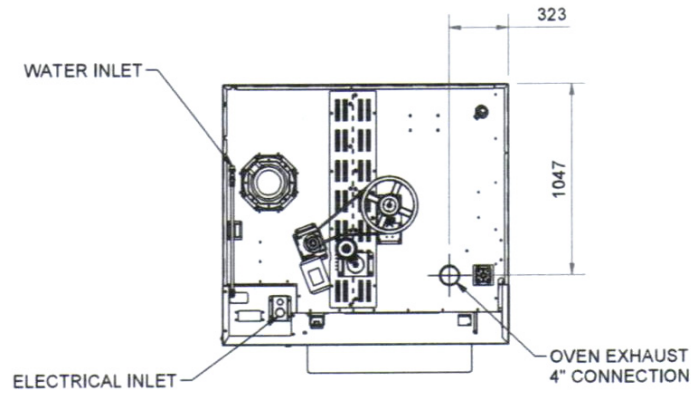
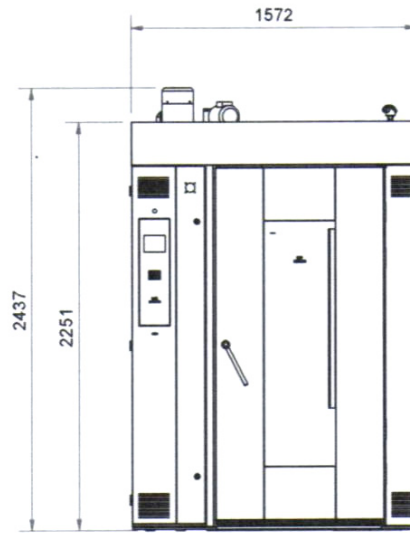
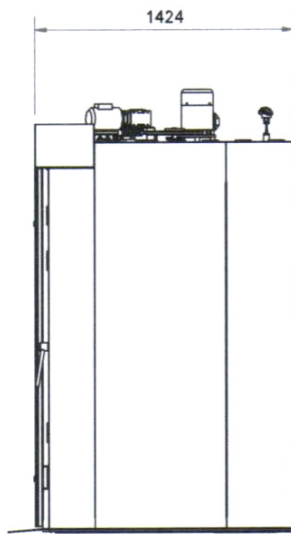

3.0 SPECIFICATIONS

Product

Designation: Oven

Electrical



Warning

The supply to this oven **must be protected** by a 30mA residual current device (RCD).

Power supply: 415V 3ph + N + E
50Hz 47kW – 65amps per phase
Low power version
415V 3ph + N + E
50Hz 38kW – 53amps per phase
Larger 60 x 80 tray version
415V 3ph + N + E
50Hz 56kW – 80amps per phase

Connection point: See section - *Dimensions*

Mechanical

Width/depth/height: See section - *Dimensions*
Maximum tray size: 762mm (30") x 457mm (18")
Air circulation: Radial fan is driven by an electric powered motor – 1.5 kW
Steam system: Mass energy storage, no drain
Rack rotation: Electric powered motor/gearbox (0.18 kW) driven via belt drive
Hanger inside the baking chamber.
Rack turntable fitted to selected models (FG166-E****TT), compatible with a range of standard racks. Contact Mono Equipment to check for compatibility.

Materials

No materials containing asbestos have been used in the construction of this oven.

Heating system

Fuel: Electricity
Output: 45kW (15 elements of 3kW)
Low power version - 36kW (12 elements of 3kW)

Flue system

Flue connection: See section - *Dimensions*

Rack rotation

The rack hanger is driven by an electric motor situated on the mid left-hand side of the oven roof. Power transmission to the rack-hanger's central drive shaft is by means of a single tensioned V-belt that affords slippage of the transmission in the event of a blockage to rack rotation.

A rack turntable option is fitted to selected models (FG166-E****TT), allowing the use of a range of standard racks in the MONO MXTE oven.

Air circulation system

An electrically powered radial fan re-circulates air within the oven. Heated air enters the fan at the upper left-hand side of the oven and is driven within the roof structure to the vertically orientated air door at the rear corner of the baking chamber. Adjustable openings in the air door allow the amount of air entering the baking chamber at various heights to be adjusted to get the optimum baking result.

The air door openings are set at the factory and should not require resetting. The factory settings are given in section – *Setting the Air Slots* for reference. Should these factory setting fail to give a satisfactory baking performance then instructions for adjusting the openings are given.

Steam system

The steam generating system is completely contained within the oven and situated at its left hand side in the lowermost region of the air duct, outside of the baking chamber. Only cold water, at a pressure of 4 – 6 bar (58 – 87 PSI), needs to be connected to the oven for the purpose of steam generation.

From a cold oven start the steam system will typically require 20 minutes to accumulate sufficient energy to produce satisfactory steaming performance; and during repeated baking cycles it automatically re-energises itself during the bake cycle. No drain is required for the steam system.

Under normal conditions of use this oven is not considered a pressure vessel.

Heating System

Heat is transferred to the baking chamber through the interaction of re-circulating air passing over the hot surfaces of the heating elements.

Electrical connection

The oven is fitted with built-in automatic fuses, situated in the uppermost region of the compartment behind the control door. The fuses are marked and can be accessed when the control door is opened.

Ventilation

To ensure the correct operation of the roof-mounted components the ambient temperature should not exceed 50 °C. The oven requires zero clearance on left, right and rear vertical faces for operation or maintenance.

Extraction

Airborne emissions from the baking process, such as steam, oil, etc., will be discharged from the overpressure duct and the damper duct; both situated at roof level towards the front of the oven. Discharge will also occur from the front of the oven upon opening the door at the end of a bake.

See also section – *Installation*.

Noise

Emission of airborne noise is less than 70dB.

4.0 SAFETY

***In the interest of safety and efficient operation of the oven, it is essential that this manual should be made available to the operator before work is commenced.
The following points should be observed and followed at all times.***

- 1 This oven is designed for baking bread, confectionery and savoury bakery products. Do not use it for other items without consulting with **MONO**.
- 2 It is essential for proper and safe operation of the oven that users are familiar with its operation and use.
Read the instructions provided in this document before use.
- 3 This appliance is not intended for residential use.
- 4 This appliance is not intended for outdoor use.
- 5 Unauthorised service or repairs to these ovens may cause personal injury or damage to the equipment, which may invalidate warranty agreements.



- 6 Only qualified engineers appointed by MONO EQUIPMENT should carry out service and repairs to this equipment. Electrical panels and electrical distributor boxes should not be opened until the main electrical supply to the oven has been turned off.

- 7 All connections to this oven must be made in accordance with the statutory and technical regulations of the country in which the oven is installed.



- 8 When work is being carried out inside the oven, the electrical mains isolator must be turned off and locked. The baking compartment door should be wedged open and a suitable warning notice hung on the door to prevent it being accidentally closed



- 9 While the oven is in operation, and for some time after having been in operation, it is dangerous to touch the window glass or the metal surfaces in its vicinity. The oven must be allowed to cool before any form of cleaning is started.

- 10 Use only **MONO** spare parts for this oven.

- 11 The construction of the oven must not be changed.



- 12 Oven gloves should be worn when moving products in or out of the oven.

- 13 The owner of the oven is **legally obliged to instruct staff** using the oven in its operation and in these safety regulations. The instruction manual for the oven must not be removed from the oven work area.



WARNING: WHEN DOING ANY MAINTENANCE ON TOP, KEEP CLEAR OF THE RECTANGULAR FLUE PIPE TOWARDS THE FRONT RIGHT HAND SIDE OF THE ROOF. VERY HOT AIR IS EJECTED.



14. Moving parts remain unguarded on the oven roof as this area is out of reach of the operator and therefore deemed safe. Care must be taken to avoid these motorised parts when maintenance tasks are performed.
15. Unless trays/containers for the purpose of holding the oven products are supplied with the oven by the manufacturer, it is the responsibility of the customer to ensure that the nature and surface conditions of materials likely to come into contact with food shall be such that they cannot contaminate or spoil the food.
16. Up until August 2017 the oven's main door has a safety release foot-plate on its inner side allowing the door to be opened from inside in an emergency lock-in situation.

EMERGENCY INTERNAL-DOOR RELEASE

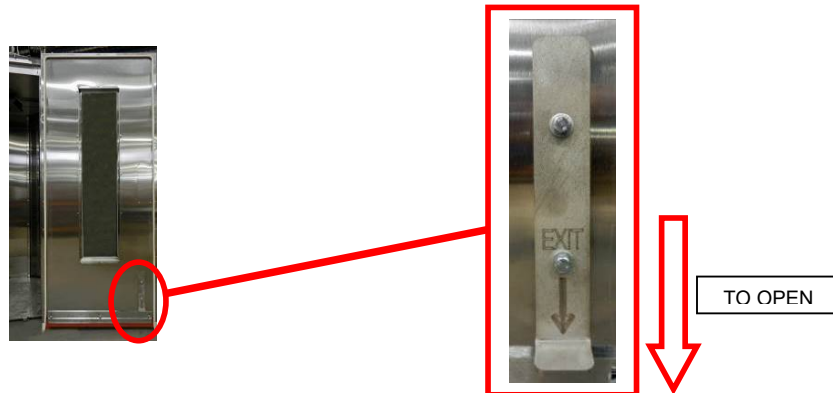

After August 2017 the oven's main door has a safety release handle on its inner side allowing the door to be opened from inside in an emergency lock-in situation.

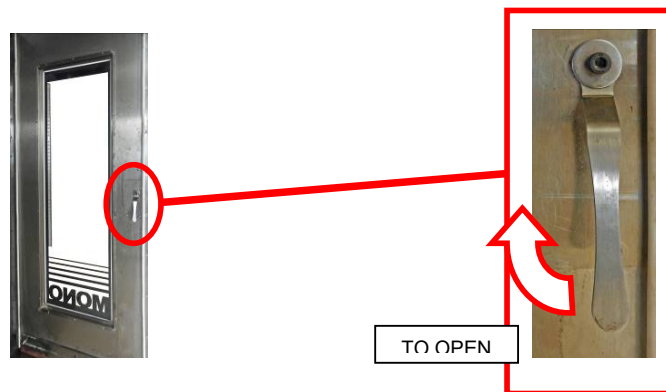

5.0 INSTALLATION

- 1 The **MONO MXE** oven is designed to operate as a freestanding unit, and must not be bolted down or fixed to the floor in any way.
- 2 The concrete floor beneath the oven must be smooth, flat and clear of any obstructions, and must be at least 150mm (6") thick.
- 3 The foundation must be flush with the overall bakery floor because racks are wheeled up a ramp (supplied with the oven) into the baking chamber.
- 4 A minimum headroom clearance of 3 metres (180") between the floor and the bakery ceiling must be maintained at all times.
- 5 WATER SUPPLY
The water supply to the oven shall be fitted with protective means against backflow in the water supply and installed according to the national regulations in force.
Customers in hard water areas must ensure that an efficient water treatment device protects the supply to the oven. It is the customers' responsibility to install and maintain an adequate water supply to the oven, which should comply with local water regulations.

Connect to a suitable water supply, making sure that the pipes are flushed out to remove all foreign bodies i.e. flux or solder.

NOTE

Set up of the pressure regulator should not be required as it is factory set to the optimum setting to provide the best steam during a bake.

7. Oven evacuation --- Canopy/Hood

It is recommended that evacuation of the oven baking chamber products is achieved with a hood covering the entire oven top and projecting beyond the front of the oven by 600mm. the extraction rate from the hood should be approximately 1700m³/h.

The customer is responsible for providing adequate levels of make-up air if an extraction hood is fitted.

How to load the oven when a rack turntable is fitted (FG166-E****TT models only)



Caution

Surfaces on the oven will be hot – always wear protective gloves and appropriate clothing (including shoes).

Before starting a bake

1. Open the oven door.
2. Ensure the foot brake (A) on the turntable is released (i.e. in the horizontal position).
3. Push the rack (B) into the oven until it reaches the back stops (C) on the turntable.

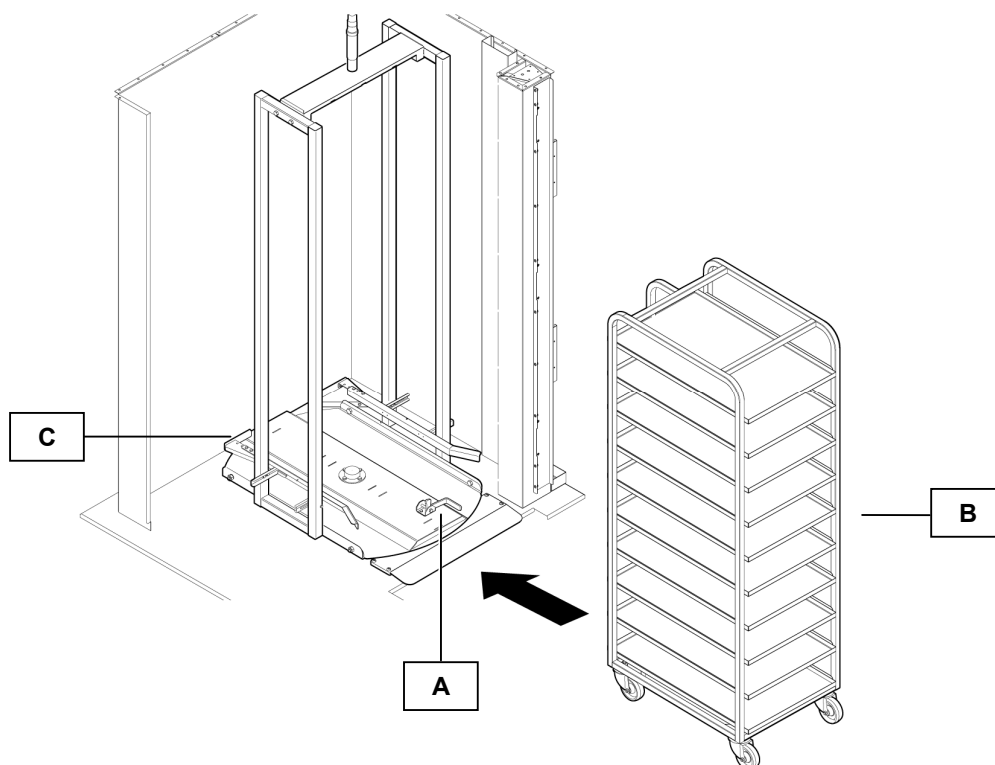

4. Put the foot brake on (i.e. move it to the vertical position).

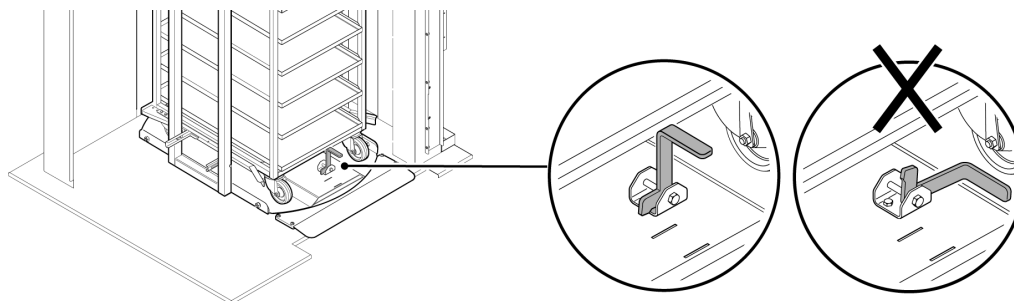

5. Close the oven door.

After baking is complete

6. Open the oven door.
7. Release the foot brake (i.e. move it to the horizontal position).
8. Pull the rack out of the oven.

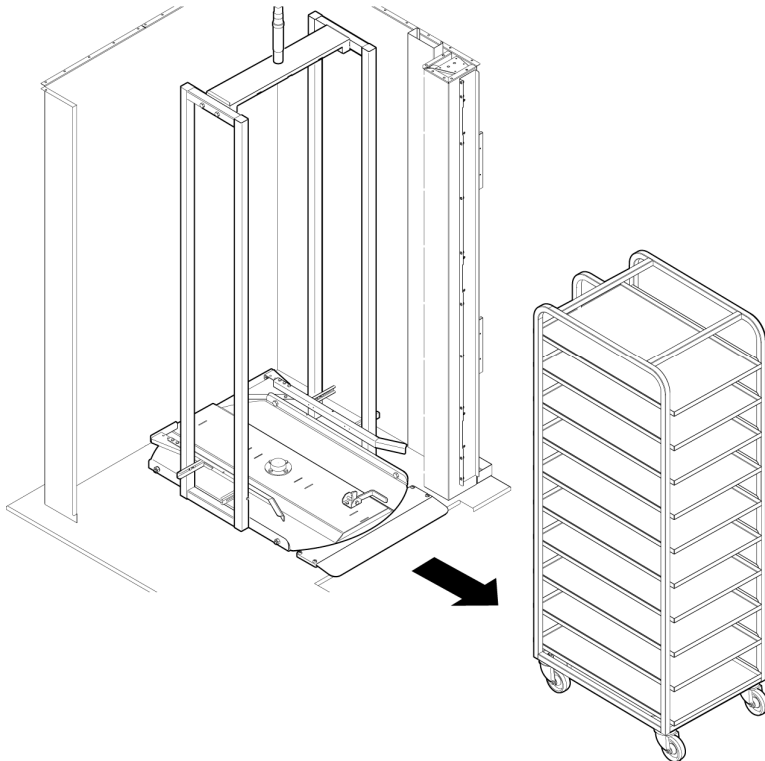

6.0 ISOLATION



In case of an emergency, switch oven off at mains electrical isolator switch.

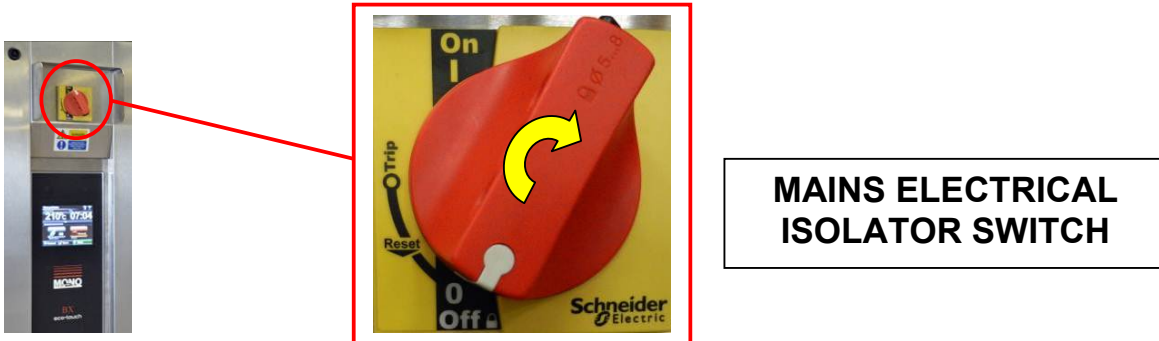

NOTE: IF WORKING ON ELECTRICAL BOX AND PANEL, ensure oven is DISCONNECTED from CONSUMER POWER SUPPLY.



NOT ONLY OVEN ISOLATOR ABOVE, AS SOME PARTS STAY LIVE AFTER ISOLATOR SWITCH IS OPERATED

7.0 CLEANING INSTRUCTIONS ---

Caution

Do not use high-pressure equipment to clean the oven.

The oven has been designed with sealed components, which are used wherever possible. The minimum of routine cleaning is required, but it is essential that it be properly and regularly carried out.

1. Sweep out debris from the oven floor daily.
2. Clean up spillages of product on the oven floor.
3. Wipe off splashes on door window.

Do not use alkaline or abrasive detergents when cleaning the oven.

Do not use detergents on the control panel overlay – wipe with a damp cloth only.

Note: *Buildup of spillages may result caused by incorrectly placed racks. Also check for damage to door seals, particularly if operators are careless with rack handling.*

8.0 GENERAL MAINTENANCE ---

To maintain the warranty conditions, the oven must undergo service at specific intervals. Below is the service program with the given intervals:

Every 3 months

Lubrication:

Door lock

Heat resistant grease

Every 12 months

Check/adjust:

Door lock mechanism

Internal door release mechanism

Lighting, including cables

Damper function

Drive belt tension

Limit positions

Water connection tightness

Solenoid valve operation

Rack hanger bearing

Function check

Chamber temperature calibration

Lighting

If the lighting in the door fails to operate, contact the Mono service dept. It cannot be replaced by the user.



Section 9

TOUCH SCREEN OPERATING INSTRUCTIONS

BASIC OPERATION

ALL OPERATIONS ARE ACTIVATED BY TOUCHING AREAS ON THE SCREEN, WHICH WILL PASS YOU ON TO THE NEXT INFORMATION PANEL.

DO NOT USE EXCESSIVE FORCE.
(THE PRESSURE REQUIRED TO OPERATE THE PANEL CAN BE ALTERED IN THE SETTINGS SECTION)

TOUCH THE SCREEN
ON THE AREA YOU
REQUIRE TO
ACTIVATE

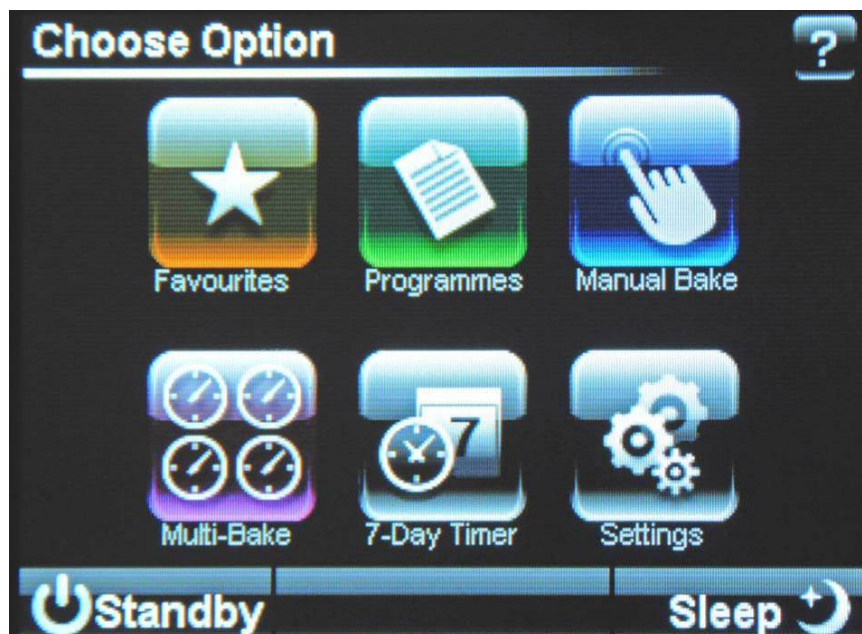

STANDBY
THE OVEN TURNS OFF.
TOUCH THE SCREEN TO GO TO
THE OPTION SCREEN.

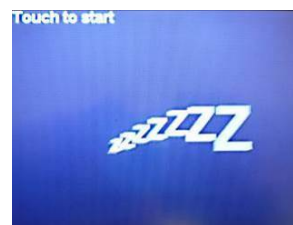

SLEEP
THE OVEN STAYS AT 100c AND
HEATS TO LAST PROGRAM
TEMPERATURE WHEN THE
SCREEN IS TOUCHED.
OPTION SCREEN THEN SHOWS.

9 -1 BAKING USING FAVOURITES MENU

TOUCH TO OPEN THE FAVOURITES SELECT SCREEN

1

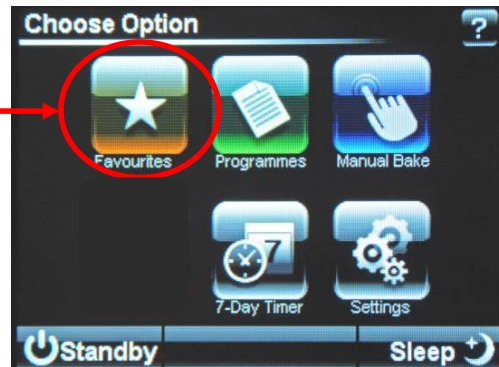

OPTION SCREEN

TOUCH THE NAME OF THE PRODUCT REQUIRED

2



SELECT SCREEN

TOUCH THE "FULL LOAD" OR "HALF LOAD" AS REQUIRED

3

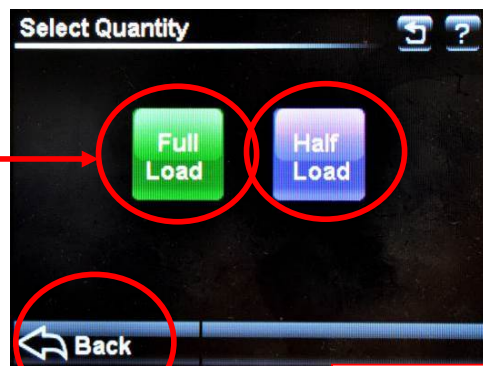

LOAD SCREEN

TO RETURN TO THE PREVIOUS SCREEN TOUCH THE "BACK" BUTTON AT ANY TIME

IF THE OVEN IS NOT UP TO TEMPERATURE IT WILL SHOW THE HEATING SCREEN.

WAIT FOR THE OVEN TO REACH TEMPERATURE

IF THE OVEN IS TOO HOT FOR THE TEMPERATURE CHOSEN, THE SCREEN WILL TELL YOU TO OPEN THE DOOR TO AID COOLING.

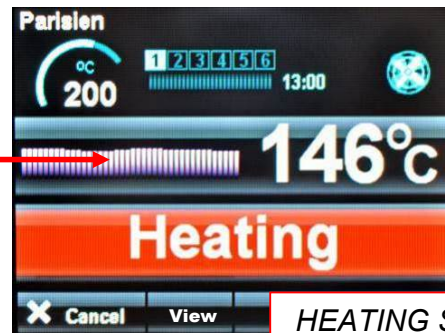

HEATING SCREEN



READY SCREEN

WHEN OVEN IS AT THE CORRECT TEMPERATURE THE "READY" SCREEN WILL SHOW.

1. OPEN DOOR AND LOAD PRODUCT.
2. CLOSE THE DOOR FULLY.
3. TOUCH "START"

TIP

TO HELP TO KEEP THE OVEN HOT, TRY NOT TO KEEP THE DOOR OPEN MORE THAN NEEDED

4

BAKE IN PROGRESS SCREEN

THIS SCREEN WILL SHOW WHILE THE PRODUCT IS BAKING

SET TEMPERATURE

TEMPERATURE PROFILE BAR

BAKE TIME PROGRESS BAR

NOTE

The actual temperature shown will rise and fall above and below the set temperature as the oven cools and reheats. This is not a fault

BAKE PHASE (WHEN USED)

ACTUAL OVEN TEMPERATURE



BAKE TIME LEFT

BAKE OVER SCREEN

AT THE END OF THE BAKE TIME A SOUNDER WILL BE HEARD AND "BAKE OVER" WILL FLASH. TOUCH "**STOP**" AND OPEN THE DOOR TO REMOVE THE PRODUCT.

TO KEEP THE OVEN BAKING FOR EXTRA MINUTES THE "+ 10 MIN" BUTTON CAN BE TOUCHED. (THIS TIME CAN BE ALTERED IN SET UP)

5



TOUCHING "VIEW" BUTTON DURING A BAKE

TOUCHING "VIEW" BUTTON DURING A BAKE WILL SHOW THE SETTINGS FOR THE BAKE IN PROGRESS. TOUCH "CANCEL" TO GO BACK TO THE PREVIOUS SCREEN.



VIEW SCREEN

9 - 2 BAKING USING MANUAL MENU

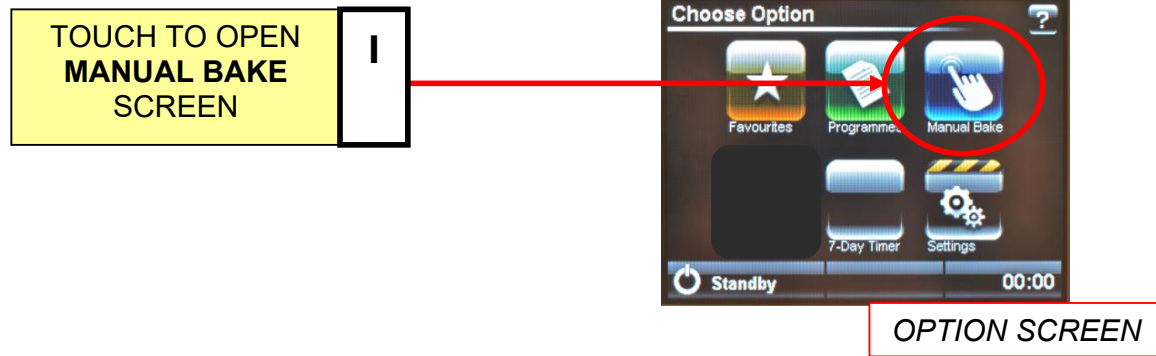

SET BAKE TIME AND TEMPERATURE



SET BAKE TEMPERATURE
TOUCH TEMPERATURE ON THE SCREEN TO ACTIVATE THE KEYBOARD SCREEN. KEY IN REQUIRED TEMPERATURE

2



SET BAKE TIME
TOUCH TIME ON THE SCREEN TO ACTIVATE THE KEYBOARD SCREEN. KEY IN REQUIRED TIME AND TOUCH "DONE"

3

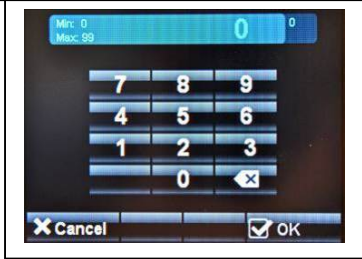

NOTE:
TIME DOES NOT HAVE TO BE SET IN MANUAL MODE. (ONLY TEMPERATURE) WHEN START IS PRESSED, THE TIME WILL COUNT UP INSTEAD OF DOWN. TOUCH STOP TO FINISH BAKE.

USE STEAM TIME AND DAMPER IF REQUIRED

STEAM
 TOUCH AND HOLD FOR THE TIME (SECONDS) STEAM IS REQUIRED. (THIS CAN BE USED BEFORE OR DURING THE BAKE)

DAMPER
 TOUCH TO OPEN THE DAMPER. (SYMBOL IS GREEN)
 TOUCH TO CLOSE THE DAMPER. (SYMBOL IS RED)



CANCEL
 TOUCH AT ANYTIME TO GO BACK TO THE SETTING SCREEN.

MANUAL BAKE SCREEN 2

START
 TOUCH "START" TO START BAKE



TOUCH "STOP" WHEN END OF BAKE BUZZER SOUNDS OR WHEN REQUIRED IF NO TIME WAS ENTERED

SAVE MANUAL PROGRAM, IF REQUIRED



MANUAL BAKE SCREEN 3

SAVE SETTINGS
IF NO TIME WAS ENTERED AT THE START OF THE BAKE, WHEN STOP IS TOUCHED "SAVE" WILL APPEAR AT THE BOTTOM OF THE SCREEN. "SAVE" CAN BE TOUCHED AND AN OPTION SCREEN WILL APPEAR.

7

TOUCH "ADD TO FAVOURITES" OR "SAVE AS"



USE KEYBOARD TO TYPE THE REQUIRED NAME AND TOUCH "SAVE"



NOTE: In manual mode, only one operation of the steam or damper is saved.

9 - 3 BAKING USING PROGRAMMES MENU

NOTE : THIS COVERS TWO VERSIONS OF FIRMWARE. (THE OVEN CAN BE PRE-SET TO SHOW ONLY ONE OF THEM).
 1. **PICTORIAL** VERSION SHOWS CHOICES OF PRODUCT CATERGORIES
 2. **NUMERICAL** VERSION SHOWS RANGES OF PROGRAM NUMBERS.

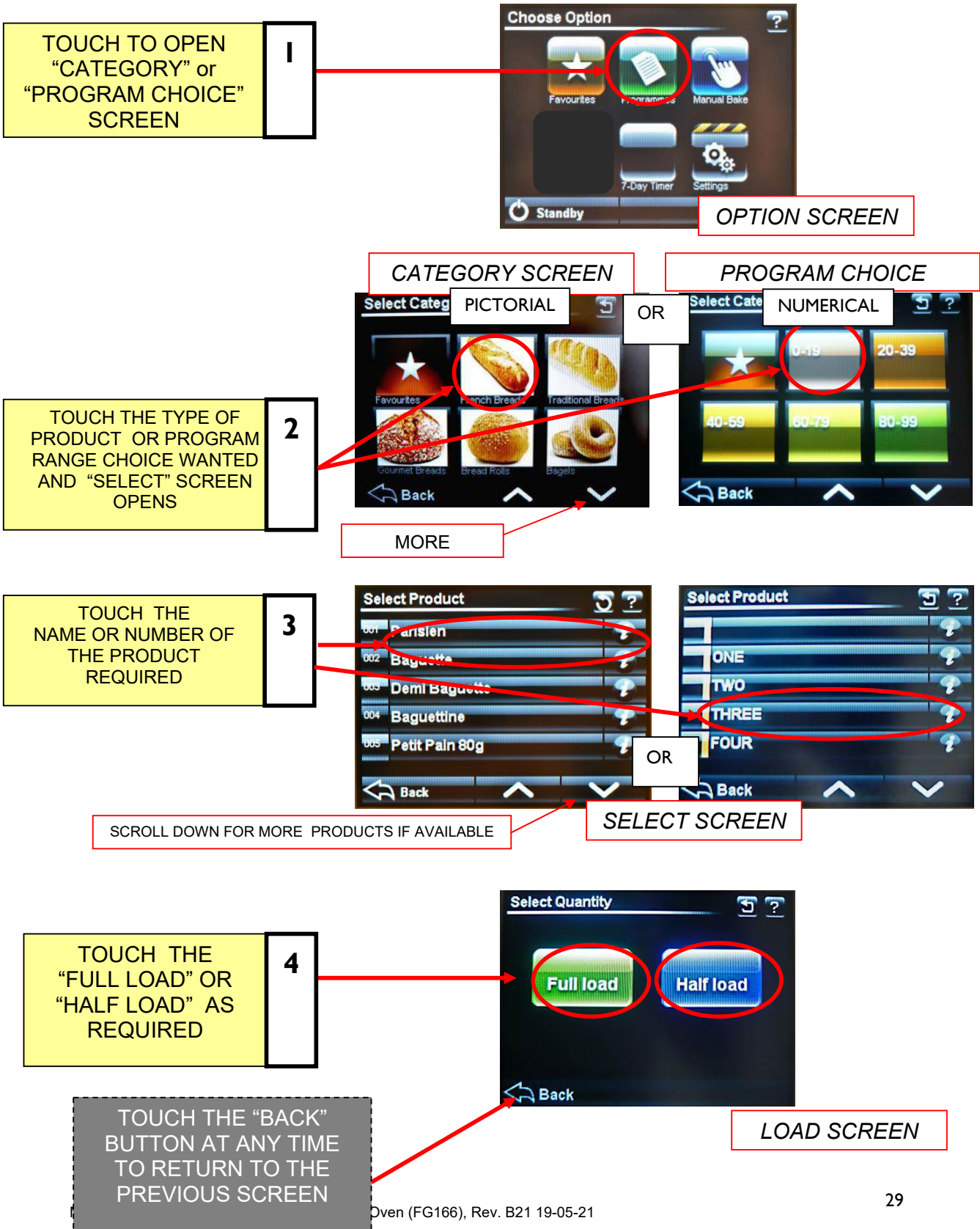

IF THE OVEN IS NOT UP TO TEMPERATURE IT WILL SHOW THE HEATING SCREEN.

WAIT FOR THE OVEN TO REACH TEMPERATURE

IF THE OVEN IS TOO HOT FOR THE TEMPERATURE CHOSEN, THE SCREEN WILL TELL YOU TO OPEN THE DOOR TO AID COOLING.

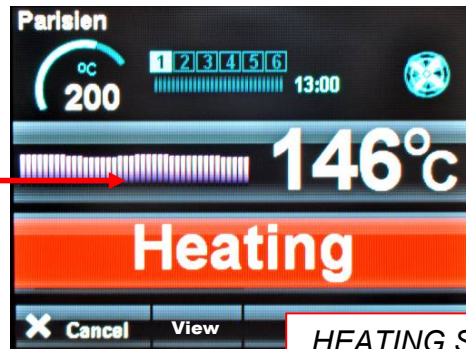

HEATING SCREEN



READY SCREEN

WHEN THE OVEN IS AT THE CORRECT TEMPERATURE, THE "READY" SCREEN WILL SHOW.

1. OPEN DOOR AND LOAD PRODUCT.
2. CLOSE THE DOOR FULLY.
3. TOUCH "START"

TIP

TO HELP TO KEEP THE OVEN HOT, TRY NOT TO KEEP THE DOOR OPEN MORE THAN NEEDED

5

THIS SCREEN WILL SHOW WHILE THE PRODUCT IS BAKING

BAKE PHASE (WHEN USED)

ACTUAL OVEN TEMPERATURE

SET TEMPERATURE

TEMPERATURE PROFILE BAR

BAKE TIME PROGRESS BAR



BAKE TIME LEFT

NOTE

The actual temperature shown will rise and fall above and below the set temperature as the oven cools and reheats. This is not a fault

BAKE OVER SCREEN



6

AT THE END OF THE BAKE TIME A SOUNDER WILL BE HEARD AND "BAKE OVER" WILL FLASH. TOUCH "STOP" AND OPEN THE DOOR TO REMOVE THE PRODUCT.

TO KEEP THE OVEN BAKING FOR EXTRA MINUTES THE "+ 10 MIN" BUTTON CAN BE TOUCHED. (THIS TIME CAN BE ALTERED IN SET UP)

TOUCHING "VIEW" BUTTON DURING BAKE



TOUCHING "VIEW" BUTTON DURING BAKE WILL SHOW THE SETTINGS FOR THE BAKE IN PROGRESS. TOUCH "CANCEL" TO GO BACK TO THE PREVIOUS SCREEN.



VIEW SCREEN

9 - 4 CREATING A PROGRAM

TOUCH TO OPEN
"CATEGORY"
SCREEN

1



OPTION SCREEN

TOUCH THE TYPE
OF PRODUCT
WANTED AND THE
"SELECT" SCREEN
OPENS

2



CATEGORY SCREEN



SELECT SCREEN

TOUCH THE DOWN ARROW
UNTIL A BLANK PROGRAM
IS REACHED.

3

TOUCH "1" BUTTON
NEXT TO THE BLANK
PROGRAM TO OPEN
NEXT SCREEN

4

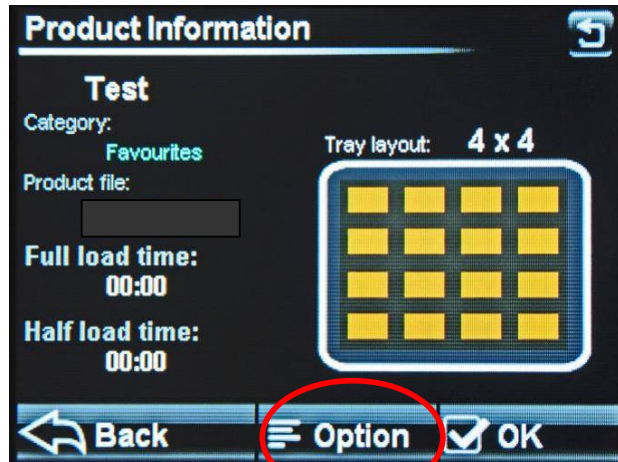

INFORMATION SCREEN

TOUCH OPTION TO GO TO
PASS CODE SCREEN

5

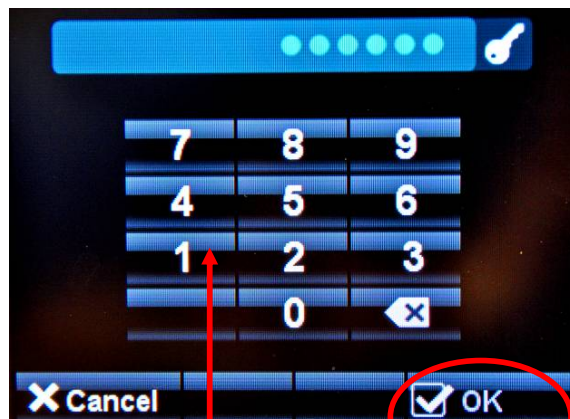

PASS CODE SCREEN

ENTER "SUPERVISOR" PASS CODE AND
THEN TOUCH OK.
(DEFAULT CODE = 123456)

6

CHANGE PRODUCT

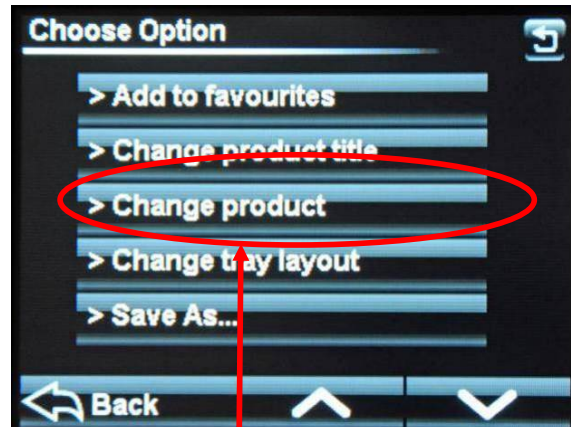

OPTION SCREEN

TOUCH "CHANGE PRODUCT"

7

LOAD TYPE

VALUE CHANGE SCREEN

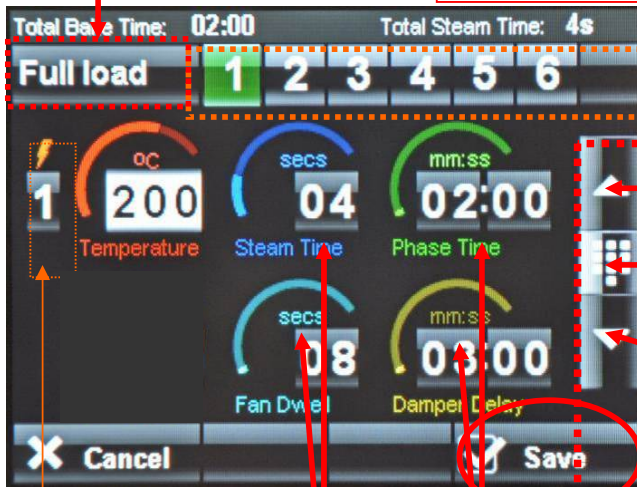

BAKE PHASE (IF REQUIRED)

INCREASE

OR USE KEYS

DECREASE

ENTER AMOUNT REQUIRED AND TOUCH DONE

POWER LEVEL

TOUCH EACH ITEM AND CHANGE THE VALUE BY USING THE UP AND DOWN KEYS OR BY USING THE KEY PAD.

8

TOUCH "FULL LOAD" TO CHANGE TO "HALF LOAD" SETTINGS IF REQUIRED. TOUCH AGAIN TO GO BACK TO "FULL LOAD"

TOUCH "SAVE" WHEN SATISFIED WITH THE SETTINGS OF EACH LOAD TYPE.

CHANGE TRAY LAYOUT

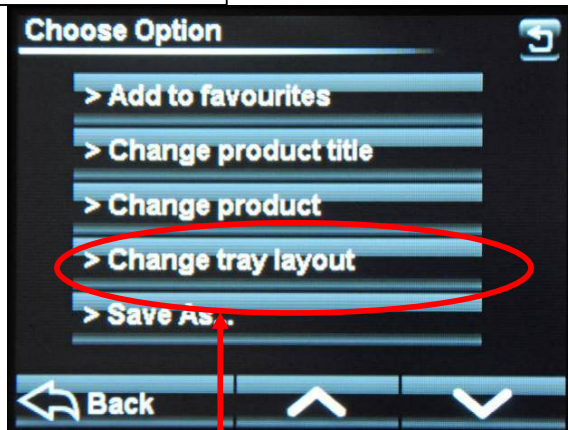

OPTION SCREEN

TOUCH "CHANGE TRAY LAYOUT"

9

TOUCH TO ADJUST
NUMBER OF PRODUCTS
ACROSS THE TRAY

TOUCH TO ADJUST
NUMBER OF PRODUCTS
DOWN THE TRAY

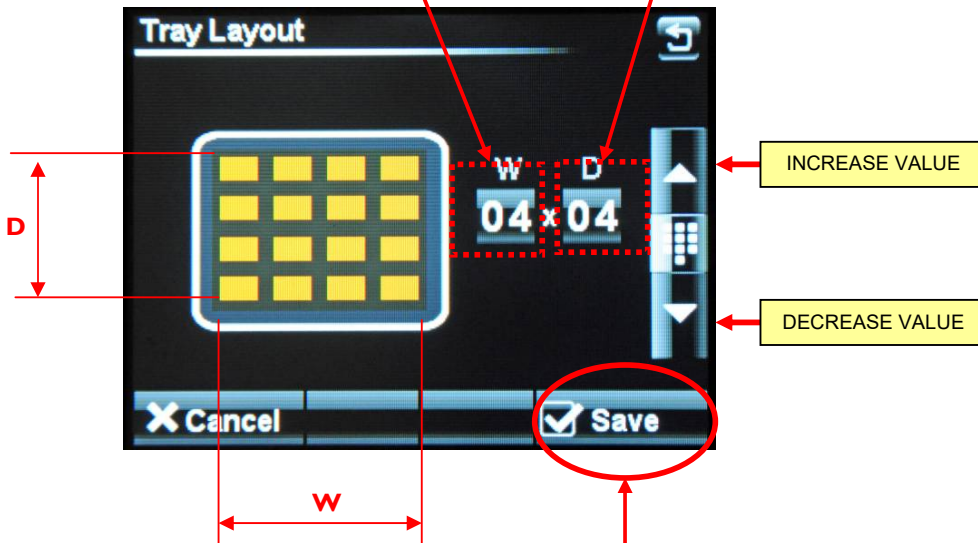

WHEN SATISFIED WITH THE TRAY
LAYOUT TOUCH SAVE TO RETURN TO
THE "OPTIONS" SCREEN

10

SAVE

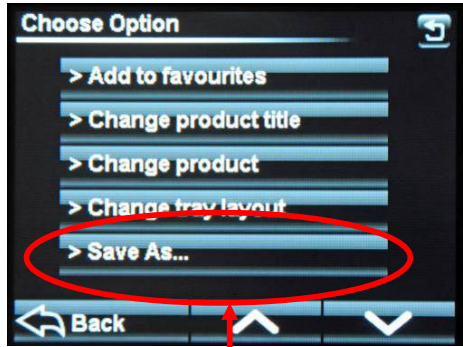

OPTION SCREEN

TOUCH "SAVE AS" 11



KEYBOARD SCREEN

TYPE IN THE NEW NAME AND TOUCH "SAVE" 12

ADD A PRODUCT TO THE FAVOURITES LIST

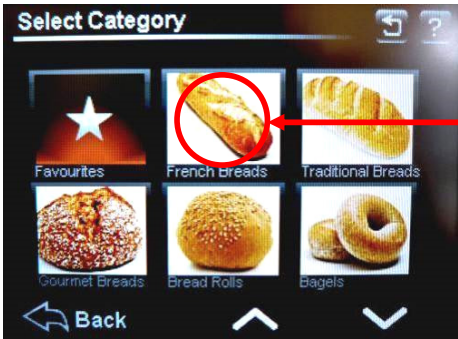

CATEGORY SCREEN

TOUCH THE TYPE OF PRODUCT WANTED AND THE "SELECT" SCREEN OPENS

1



SELECT SCREEN

TOUCH THE "i" (INFORMATION) BUTTON NEXT TO THE PRODUCT YOU WANT AS A FAVOURITE. THIS OPENS THE OPTION SCREEN

2

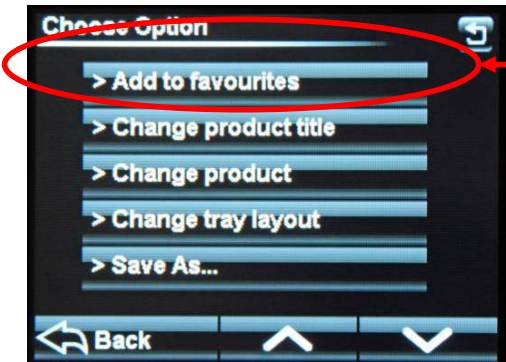

OPTION SCREEN

TOUCH "ADD TO FAVOURITES" THE PRODUCT WILL NOW SHOW ON THE FAVOURITES LIST

3

9 - 5 SETTING 7-DAY TIMER



CHOOSE DAY

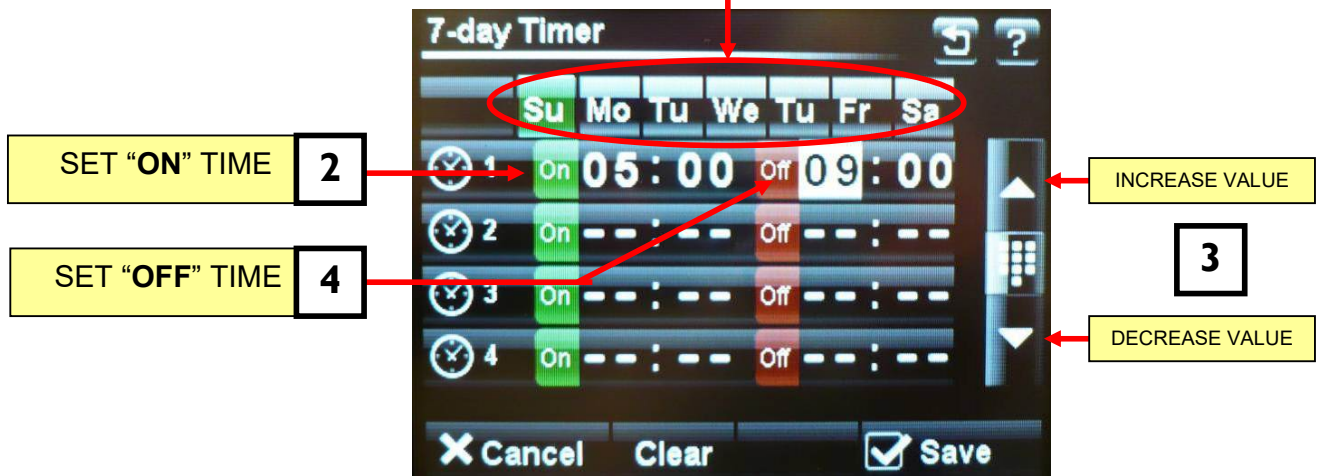

TIMER SETUP SCREEN

NOTE
 Up to four on/off times can be set for each day.
 Touch "clear" to clear the settings on the day shown.
 Touch "save" to activate the times set.

9 - 6 SETTINGS



TOUCH TO OPEN THE "SETTINGS" SCREEN

OPTION SCREEN



PASS CODE SCREEN

ENTER "SUPERVISOR" PASS CODE AND THEN PRESS OK. (DEFAULT CODE = 123456)

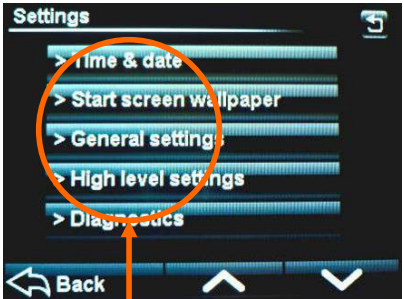

SETTINGS SCREEN

CHOOSE THE SETTING TO ALTER

TIME AND DATE

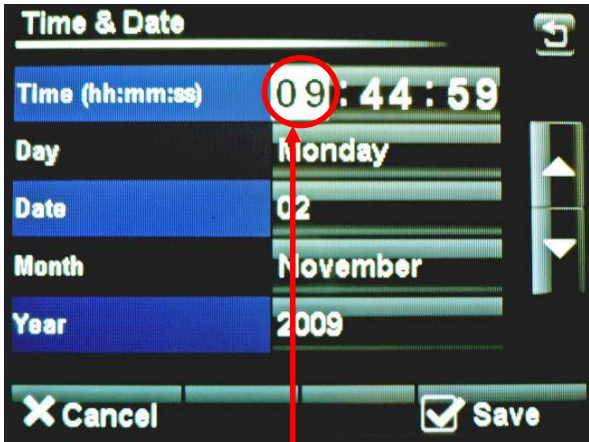

TOUCH THE SCREEN TO HIGHLIGHT THE ITEM TO CHANGE **1**

USE THE INCREASE / DECREASE BUTTONS TO ALTER THE SETTINGS **2**

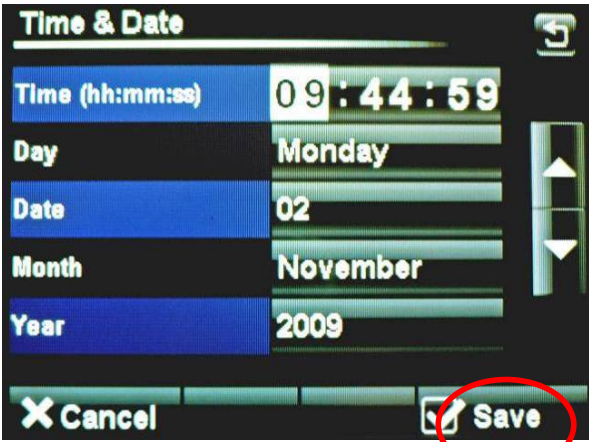

TIME AND DATE SCREEN

WHEN ALL INFORMATION IS CORRECT, TOUCH "SAVE". THIS WILL RETURN TO THE SETTINGS SCREEN **3**



SETTINGS SCREEN

OVEN SETTINGS (GENERAL)

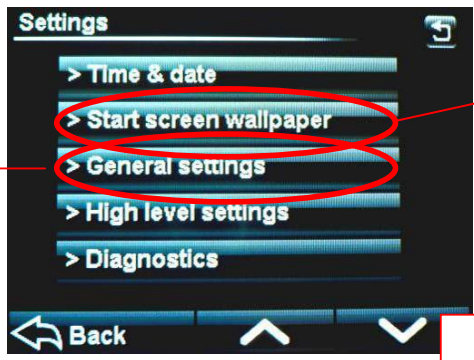

SETTINGS SCREEN

TOUCH "GENERAL SETTINGS" AND THE FOLLOWING SCREEN WILL APPEAR.
 SCROLL DOWN TO MOVE THROUGH ALL CHOICES
 AND ADJUST EACH ONE AS REQUIRED, USING THE ARROW KEYS.

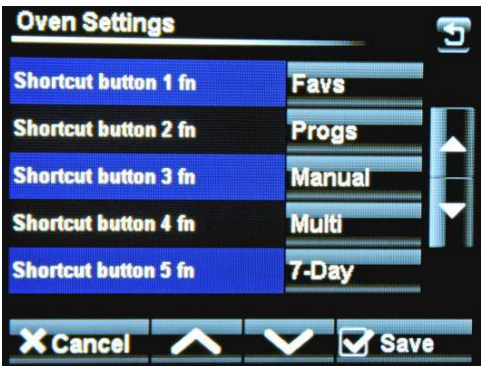
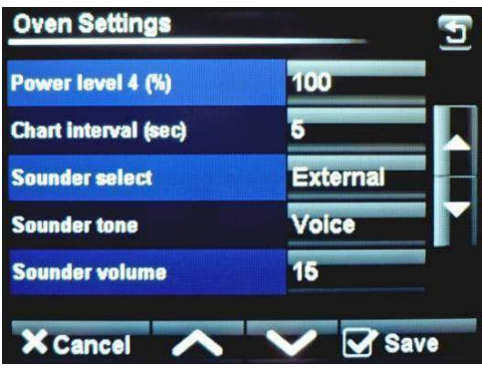
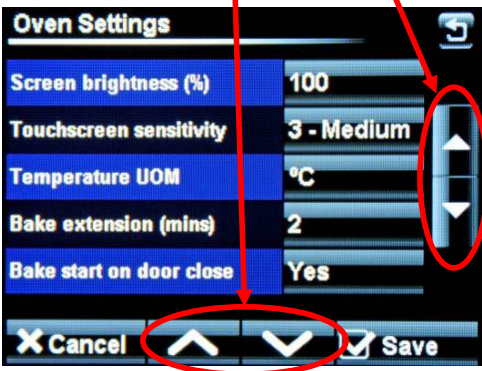

OVEN SETTINGS EXPLAINED - GENERAL LEVEL

SCREEN BRIGHTNESS –

Adjusts the brightness of the viewing screen for user comfort.

TOUCHSCREEN SENSITIVITY –

Adjusts the pressure required to operate the touch screen. (5 settings)

TEMPERATURE UNIT OF MEASURE –

Centigrade (Celsius) or Fahrenheit

BAKE EXTENSION (mins) –

Adjusts the extra time at the end of a bake for each "extra time" button touch. (10mins max)

BAKE START ON DOOR CLOSE –

This will start the set bake program as soon as the door closes.

SLEEP MODE DELAY –

Oven will go into sleep mode after the set minutes, providing it is up to temperature and has been through at least one bake cycle.

8 HOUR COUNTDOWN TIMER –

After 8 hours the oven gives a warning and then turns off.
Touch any button for an extra hour if required.

POWER LEVEL (1-4) –

Set these as required for each level to be used.

CHART INTERVAL –

Time interval in seconds that the bars show on the heat and bake time progress charts.

SOUNDER SELECT –

Set as external or onboard.

SOUNDER TONE –

Select a tone – Voice or Off

SOUNDER VOLUME –

Adjust to suit the volume required. (onboard sounder only)

SHORTCUT BUTTONS –

1 fn
2 fn
3 fn
4 fn
5 fn

<p>Gives the choice of what buttons are active and in which order they appear on the options screen. Options available = Favourites, Programs, Manual bake, Multi bake, 7-day timer . (Settings at 6fn cannot be changed)</p>
--

OVEN SETTINGS (HIGH LEVEL)

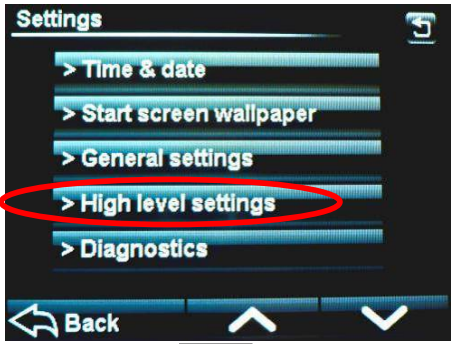

TOUCH "HIGH LEVEL SETTINGS" AND THE FOLLOWING SCREEN WILL APPEAR.

1

SETTINGS SCREEN



ENTER "HIGH LEVEL" PASS CODE AND THEN TOUCH OK.

2

THE FOLLOWING SCREEN WILL APPEAR.

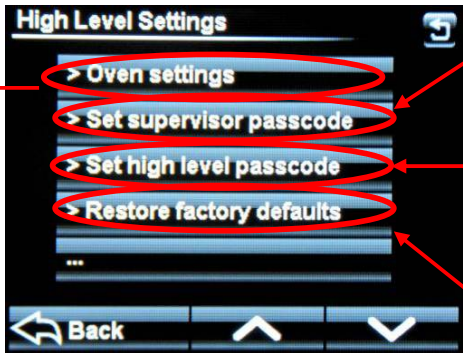

CHANGE SUPERVISOR PASSWORD HERE

CHANGE HIGH LEVEL PASSWORD HERE

RESTORES ALL SCREENS BACK TO ORIGINAL DEFAULT SETTINGS (NOT PASSCODES)

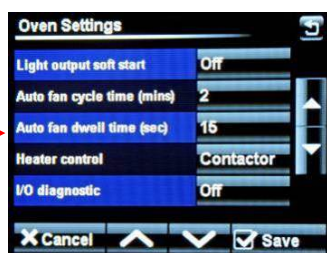
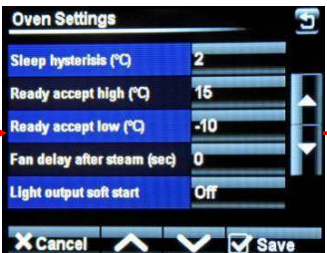

SCROLL DOWN TO MOVE THROUGH ALL CHOICES AND ADJUST EACH ONE AS REQUIRED, USING THE ARROW KEYS.

3

OVEN SETTINGS EXPLAINED - HIGH LEVEL

OVEN TYPE –

Set this to MX.

MAX. BAKE TEMPERATURE –

Can be set up to 300C , (depending on the oven type)

TEMPERATURE OFFSET –

Can be used to adjust the display to the actual temperature in the oven.

BAKE HYSTERISIS –

Sets bake temperature cycling around a set point. (Above and below).

SLEEP FALLBACK –

Temperature of the oven in "sleep mode" (100C is suggested).

SLEEP HYSTERISIS –

Sets "sleep mode" temperature cycling around a set point. (Above and below).

READY ACCEPT HIGH –

Highest temperature for the oven to display "READY"

READY ACCEPT LOW –

Lowest temperature for the oven to display "READY"

FAN DELAY AFTER STEAM –

Delay before fan starts after the oven has steamed. (60 seconds max)

LIGHT OUTPUT SOFT START –

On/Off Some lights need this for cold start up to stop them blowing.

AUTO FAN CYCLE TIME (MINS) –

Set time required. Only used in manual and multibake modes.

AUTO FAN DWELL TIME –

Set time required. Only used in manual and multibake modes.

HEATER CONTROL –

Contact or solid state. Defaults to contactor. (solid state not used at the moment)

I/O DIAGNOSTIC –

Displays outputs and inputs at the top of the screen to aid fault finding if needed.

DEFAULT PASSCODES ---

SUPERVISOR (LOW LEVEL) -- 123456

HIGH LEVEL -- 654321

MASTER -- 314159 (This is fixed)

SUGGESTION

To stop unauthorised changes to the oven setup, it is suggested that this page is removed from this manual and kept in a safe place for future reference.

If tampering could be a problem, It is a good idea to change the passcodes at regular intervals.

9 - 7 USING THE USB PORT

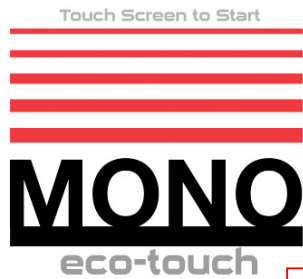

START SCREEN

Ensure the Start screen is showing

1



Insert the USB memory stick into the socket on the oven panel. (Rubber plug may have to be removed first).

2

NOTE

The USB stick will only fit in one way.
Do not force into the socket.



Wait for the USB symbol to finish moving

3

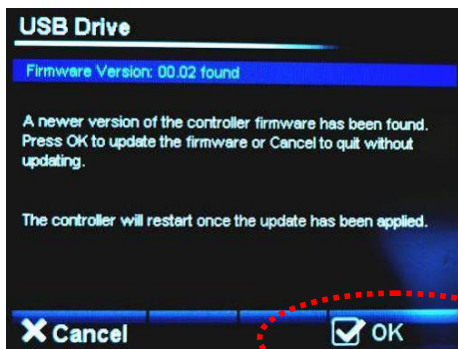

If old firmware is found, the firmware version screen will appear.

Touch "OK" to update firmware

-Wait-

Remove USB stick

OR

Touch "CANCEL" to choose other items to update or change. (see next page)

4

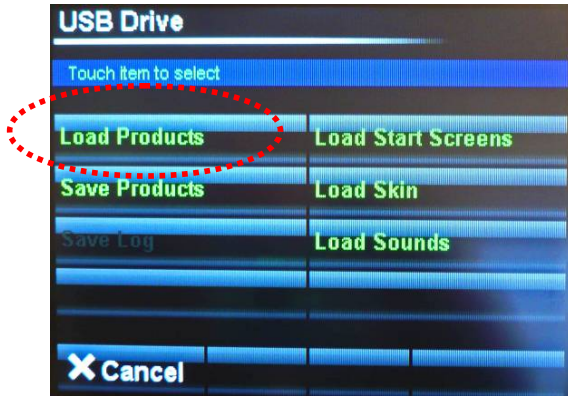

Choose action you would like to do. **5**



Select the file required. **6**



When confirmation of "file loaded ok" Shows, remove the usb stick. **7**

NOTES ON USING USB STICKS

For a USB stick to function correctly it must have the following folder in the root folder .

Mono

Then into that folder add the following:

Firmware
Products
Skins
Sounds
Start-up

Place your recipe/product files in the "**products**" folder.

The oven will find the "**Mono**" folder automatically when the stick is plugged into the oven.
Any stick can be used (does not have to be blank) but the Mono folder must be in the root folder.

The most used folders are explained below:

SKINS

These control the way the screen looks in different modes.

Pictorial is when the screen displays categories using pictures.



Numerical is when the screen displays program numbers.



STARTUP SCREENS

This is the picture/logo you see when the oven is started.



PRODUCT FILES (PROGRAM FILES)

These are the files that contain the information for baking each product e.g. bread,buns,cakes etc.

9 - 8 **DIAGNOSTICS**

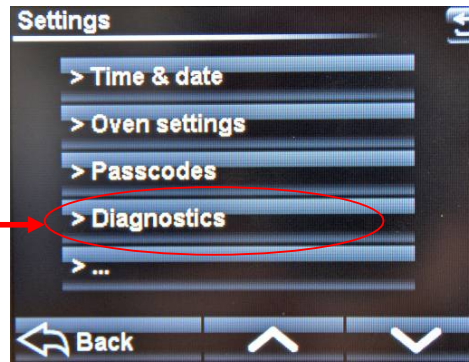

SETTINGS SCREEN

TOUCH "DIAGNOSTICS" AND THE FOLLOWING SCREEN WILL APPEAR.

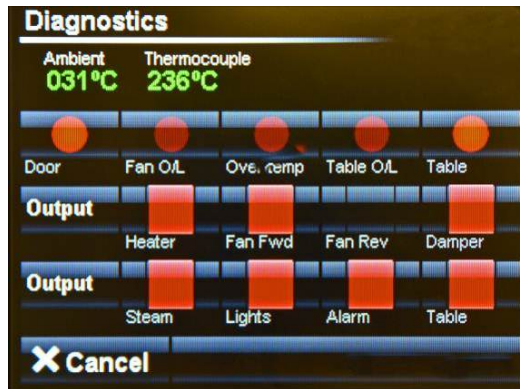

DIAGNOSTICS SCREEN

INPUTS HIGHLIGHT WHEN A SIGNAL IS RECEIVED.
e.g. DOOR OPEN

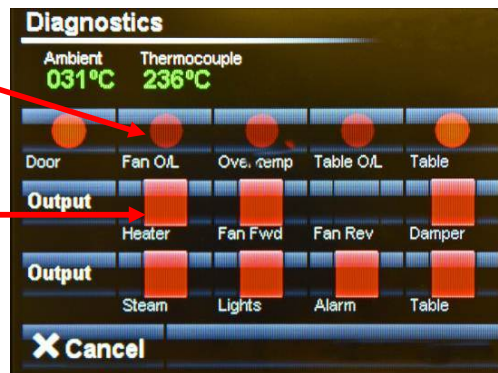

TOUCH THE REQUIRED OUTPUT AND A SIGNAL IS SENT TO THAT ITEM. THE OUTPUT BEING CHECKED IS HIGHLIGHTED WHEN ACTIVE. TO STOP THE OUTPUT, PRESS AGAIN.

10.0 TROUBLE SHOOTING

IMPORTANT!

All repairs and adjustments to the oven must be carried out by authorised experts. Isolate oven before attempting repairs or removing protective panels.

Symptom	Possible cause	Probable solution
The oven does not start, no fault shown on control panel	The main isolator switch is off. The auxiliary fuse is tripped. The main fuse is tripped.	Switch on the isolator. Reset the fuse. Change the fuse (before the oven).
Neither fan, hanger, steam or heat starts	Door is not closed. Door switch is defective.	Close door. Replace door switch.
Rack hanger does not rotate and no fault shown on control panel	Drive belt slipping. Drive belt broken	Check belt tension. Replace belt.
Oven light is not working	Lighting strip is defective. Faulty wiring to light.	Replace the light strip. Repair wiring.
Oven temperature fails to rise/rises slowly/ cannot be maintained during baking	Damper is open. Fan motor tripped. Element failure	Close damper. Reset fan trip. Call service engineer.
Little or no steam	Water mains disconnected or closed. Water spreader tube blocked. Filter in water line blocked. Solenoid valve defective.	Connect water supply or open supply valve. Clean/unblock spreader tube. Clean filter. Replace solenoid valve.
Oven bakes unevenly	Air slots not adjusted correctly. Fan motor running in the wrong direction.	Adjust air slots. See section <i>Adjusting air slots</i> . Switch electrical connections. Direction of rotation is indicated by arrow adjacent to motor.

DO NOT ATTEMPT TO MAKE ADJUSTMENTS UNLESS YOU ARE FULLY AWARE OF THE RESULTS

Setting the air slots

The oven has an air panel situated in the rear right-hand corner of the baking chamber with adjustable slots, which are accurately set prior to leaving the factory (the factory settings are given in the diagram below). It is through these slots that heated air passes into the baking chamber to perform the baking task. However, external factors can negatively affect the baking result, such as a poorly designed baking programme or the combination of trays and products to be baked, and adjustment of the air slots may be necessary.

However, before making adjustments please consider the following:

- Make sure that differences in baking results are not due to differences in product batches;
- Make sure that the plates that determine the width of the air slot have not come loose thereby causing a change from the factory setting;
- Do not be too hasty in changing air slot settings in response to a sudden change in bake evenness as this may have been caused by other factors, such as, after maintenance of the oven, or a related fault with the oven. Any adjustments to the air slots would be unlikely to cure bake unevenness under these circumstances;
- Check that the air circulation fan's rotation is correct – especially after maintenance or replacement.

If it is considered that adjustments to the air slots are necessary, these should be made in small increments and one slot at a time. Measure the slot opening before adjustment then slacken the screw(s) associated with the slot that requires adjustment, adjust slot opening then retighten screw. Measure slot opening after adjustment is complete to confirm the desired dimension has been achieved.

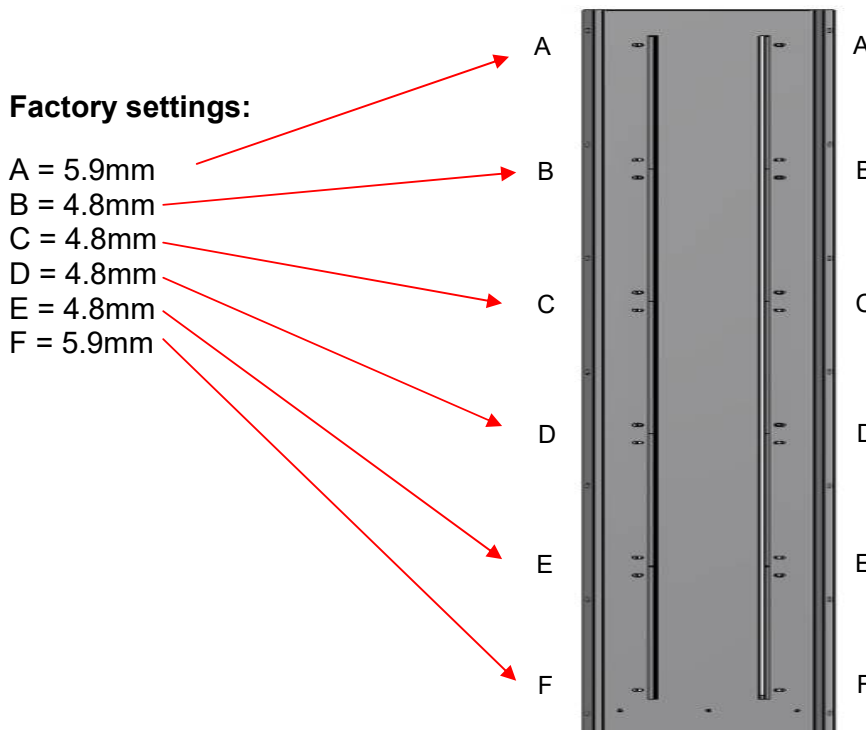

11.0 SPARES AND SERVICE

If a fault arises, please do not hesitate to contact the Customer Service Department, quoting the **machine serial number** on the silver information plate of the machine and on the front cover of this manual

All correspondence must state the details shown on the oven's identification plate.
This will reduce errors and time wasted during communication.

MONO

Queensway

Swansea West Industrial Estate

Swansea. SA5 4EB UK

email:spares@monoequip.com

Web site:www.monoequip.com

Tel. 01792 561234

Spares +44(0)1792 564039

Fax. 01792 561016



12.0 ELECTRICAL INFORMATION

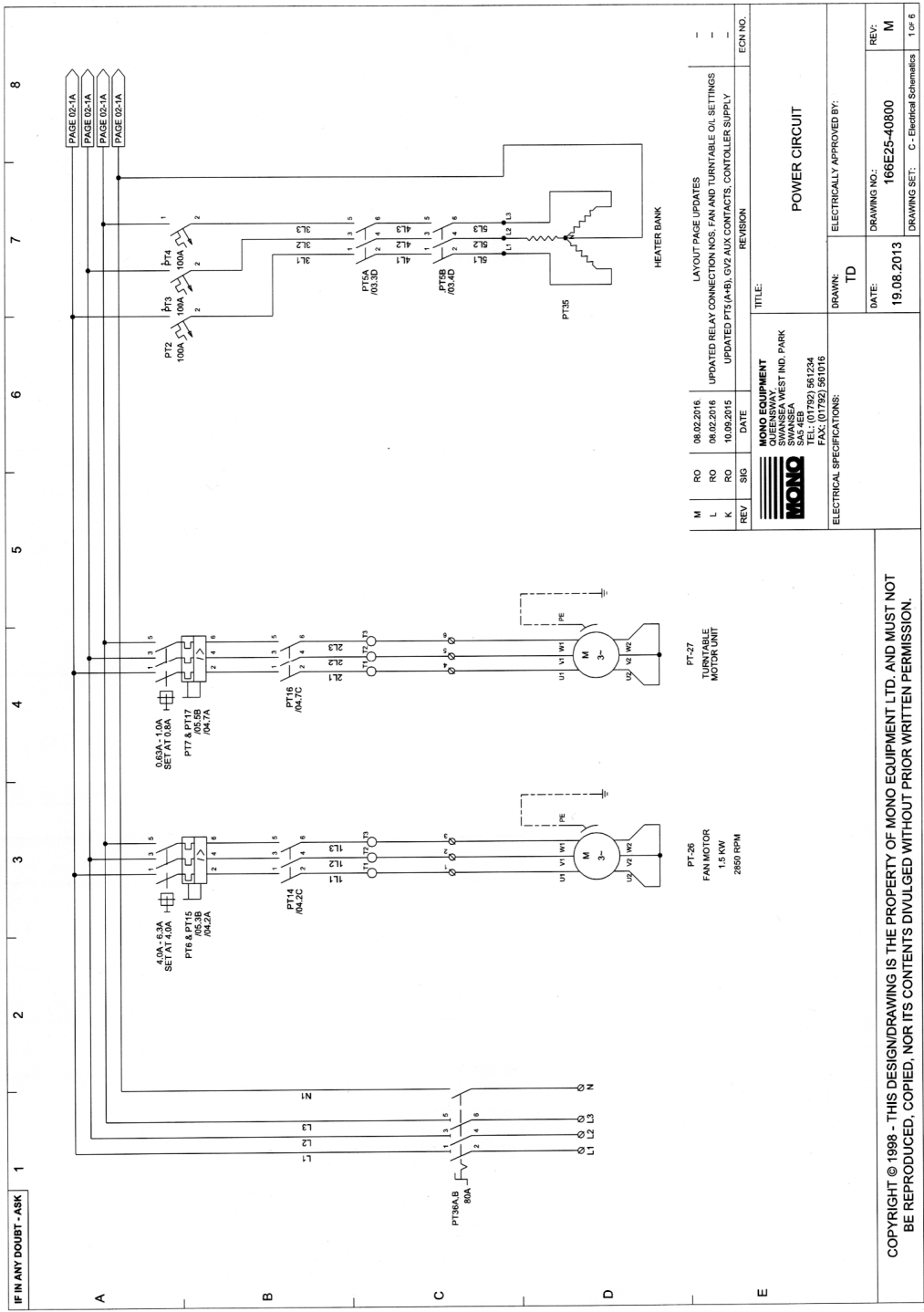

IF IN ANY DOUBT - ASK

1 2 3 4 5 6 7 8

A B C D E

PAGE 02-1A
PAGE 02-1A
PAGE 02-1A

REV	SIG	DATE	DESCRIPTION	ECH NO.
M		08.02.2016	LAYOUT PAGE UPDATES	-
L		08.02.2016	UPDATED RELAY CONNECTION NOS. FAN AND TURNABLE OIL SETTINGS	-
K		10.09.2015	UPDATED P.T.S (A,B), G.V.Z. AUX CONTACTS, CONTROLLER SUPPLY	-

MONO EQUIPMENT
 SWANSEA
 SWANSEA WEST IND. PARK
 SWANSEA
 TEL: (01792) 561234
 FAX: (01792) 561016

PT-26
 FAN MOTOR
 1.5 KW
 2850 RPM

PT-27
 TURNABLE
 MOTOR UNIT

MONO EQUIPMENT
 SWANSEA
 SWANSEA WEST IND. PARK
 SWANSEA
 TEL: (01792) 561234
 FAX: (01792) 561016

POWER CIRCUIT

ELECTRICAL SPECIFICATIONS:
 DRAWN: TD
 DATE: 19.08.2013
 DRAWING NO.: 166E25-40800
 REV: M
 DRAWING SET: C - Electrical Schematics
 1 of 6

REVISION

ELECTRICALLY APPROVED BY:

COPYRIGHT © 1998 - THIS DESIGN/DRAWING IS THE PROPERTY OF MONO EQUIPMENT LTD. AND MUST NOT BE REPRODUCED, COPIED, NOR ITS CONTENTS DIVULGED WITHOUT PRIOR WRITTEN PERMISSION.

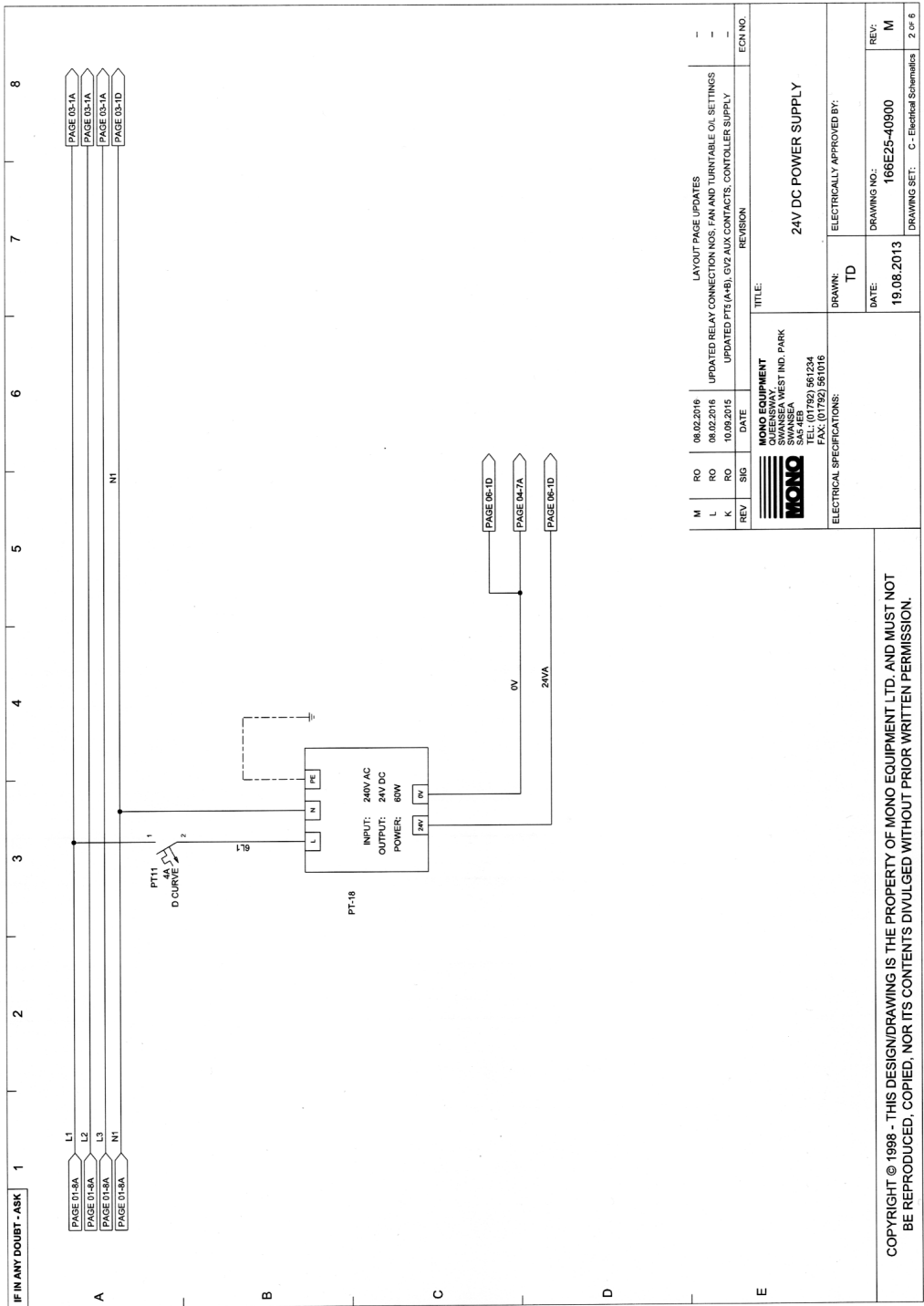

IF IN ANY DOUBT - ASK

L1 PAGE 03-1A
 L2 PAGE 03-1A
 L3 PAGE 03-1A
 N1 PAGE 03-1D

PT11
 D CURVE

RL1
 F1
 PT18

INPUT: 240V AC
 OUTPUT: 24V DC
 POWER: 60W

24V
 0V
 24VA

PAGE 04-1D
 PAGE 04-7A
 PAGE 04-1D

REV	SIG	DATE	REVISION	ECON NO.
M	RO	08.02.2016	LAYOUT PAGE UPDATES	-
L	RO	08.02.2016	UPDATED RELAY CONNECTION NOS. FAN AND TURNTABLE OIL SETTINGS	-
K	RO	10.09.2015	UPDATED P15 (A+B), GV2 AUX CONTACTS, CONTROLLER SUPPLY	-

MONO EQUIPMENT SWANSEA WEST IND. PARK SWANSEA, QUEENSLAND AUSTRALIA TEL: (01792) 961234 FAX: (01792) 351016		24V DC POWER SUPPLY	
ELECTRICAL SPECIFICATIONS:		ELECTRICALLY APPROVED BY:	
DRAWN: TD		DATE: 19.08.2013	
DRAWING NO.: 166E25-40900		REV: M	
DRAWING SET: C - Electrical Schematics		2 of 6	

COPYRIGHT © 1998 - THIS DESIGN/DRAWING IS THE PROPERTY OF MONO EQUIPMENT LTD. AND MUST NOT BE REPRODUCED, COPIED, NOR ITS CONTENTS DIVULGED WITHOUT PRIOR WRITTEN PERMISSION.

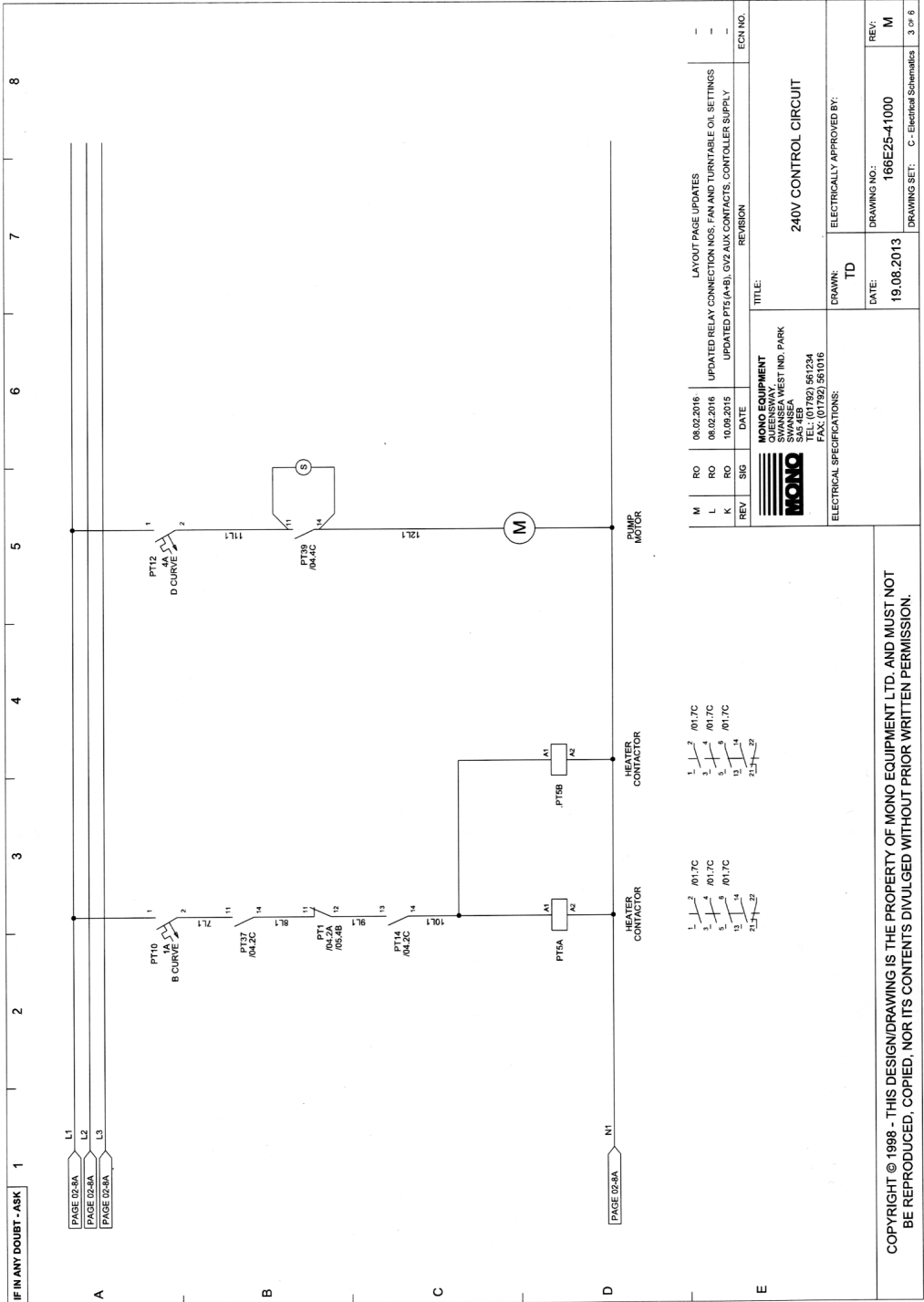

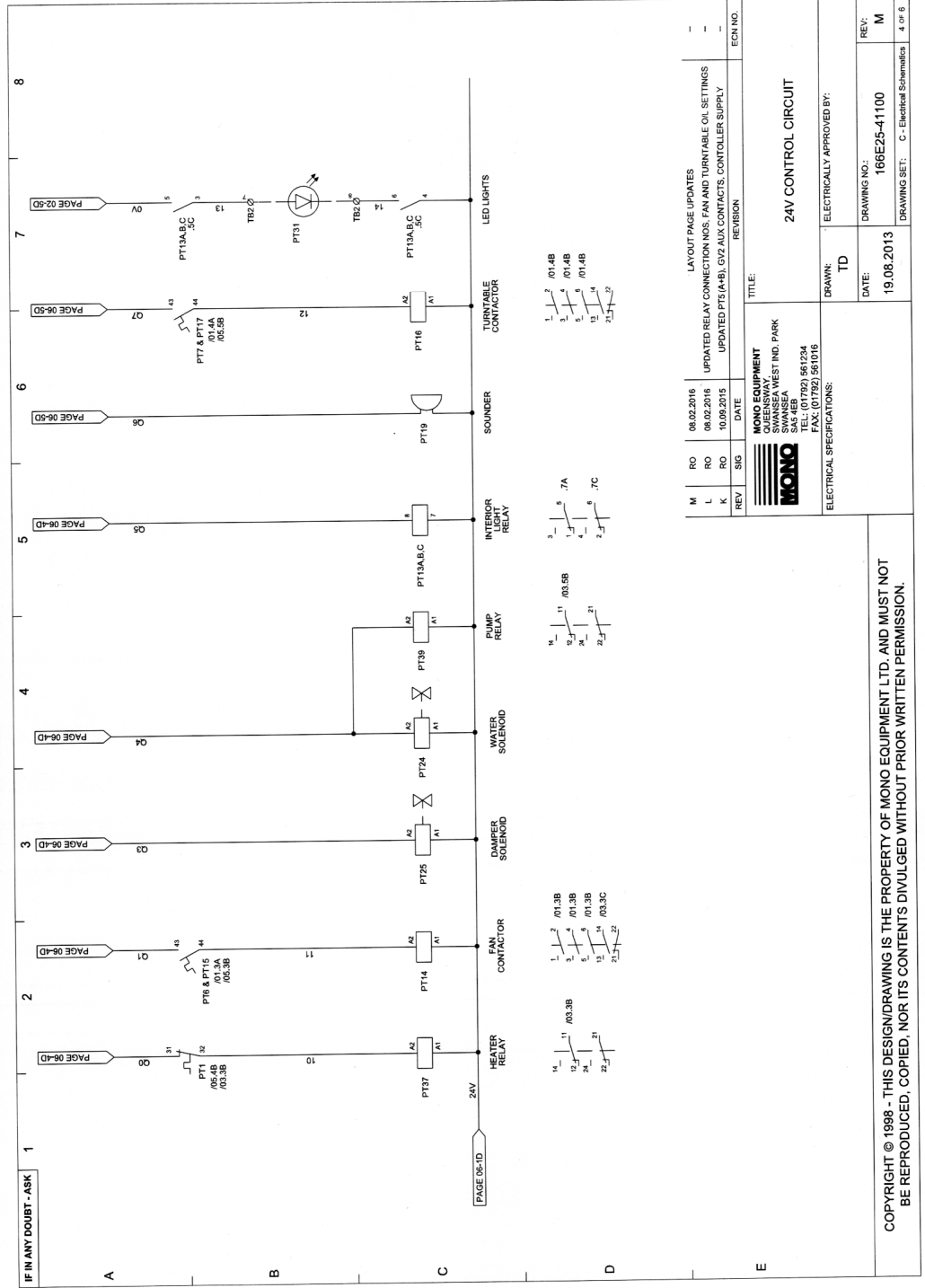

REV	SIG	DATE	DESCRIPTION	REVISION	ECH NO.
M	RO	08.02.2016	LAYOUT PAGE UPDATES	-	-
L	RO	08.02.2016	UPDATED RELAY CONNECTION NOS. FAN AND TURNABLE OIL SETTINGS	-	-
K	RO	10.09.2015	UPDATED P.T.S.(A,B), G.Y.Z AUX CONTACTS, CONTROLLER SUPPLY	-	-

MONO EQUIPMENT
 SWANSEA
 SWANSEA WEST IND. PARK
 SWANSEA
 TEL: (01792) 561234
 FAX: (01792) 561016

24V CONTROL CIRCUIT

ELECTRICAL SPECIFICATIONS:
 DRAWN: TD
 DATE: 19.08.2013
 DRAWING NO.: 168E25-41100
 REV: M
 DRAWING SET: C - Electrical Schematics 4 of 6

COPYRIGHT © 1998 - THIS DESIGN/DRAWING IS THE PROPERTY OF MONO EQUIPMENT LTD. AND MUST NOT BE REPRODUCED, COPIED, NOR ITS CONTENTS DIVULGED WITHOUT PRIOR WRITTEN PERMISSION.

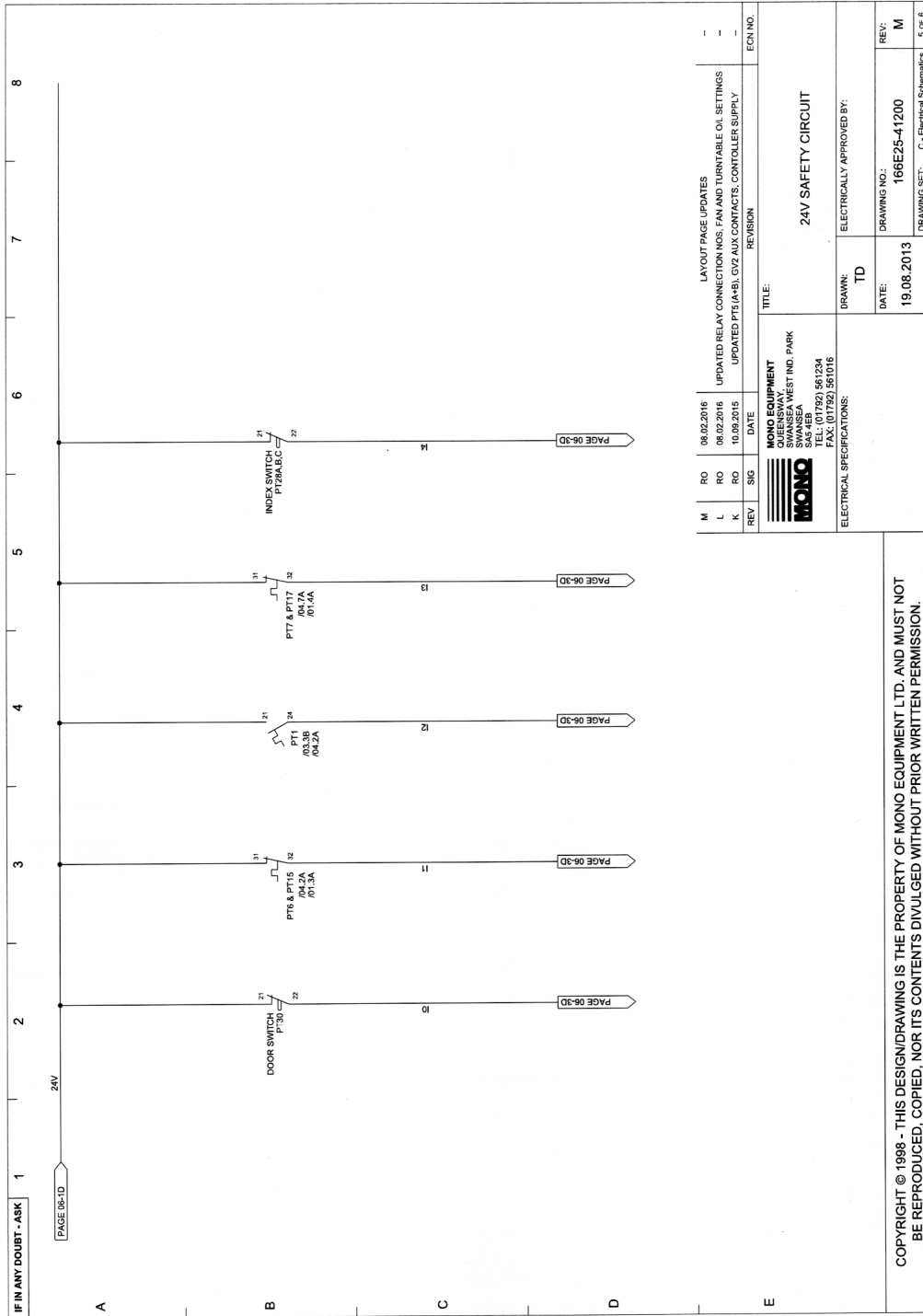

M	RO	08.02.2016	LAYOUT PAGE UPDATES	-	EON NO.
L	RO	08.02.2016	UPDATED RELAY CONNECTION NOS. FAN AND TURNABLE OIL SETTINGS	-	
K	RO	10.09.2015	UPDATED P15 (A-B), GV2 AUX CONTACTS, CONTROLLER SUPPLY	-	
REV	SIG	DATE	REVISION		
			MONO EQUIPMENT SWANSEA WEST IND. PARK SWANSEA SAH-4EB TEL: (01792) 561234 FAX: (01792) 561016		
ELECTRICAL SPECIFICATIONS:			TITLE: 24V SAFETY CIRCUIT		
DRAWN: TD			ELECTRICALLY APPROVED BY:		
DATE: 19.08.2013			DRAWING NO.: 166E25-41200		
			REV: M		
			DRAWING SET: C - Electrical Schematics		
			5 of 6		

COPYRIGHT © 1998 - THIS DESIGN/DRAWING IS THE PROPERTY OF MONO EQUIPMENT LTD. AND MUST NOT BE REPRODUCED, COPIED, NOR ITS CONTENTS DIVULGED WITHOUT PRIOR WRITTEN PERMISSION.

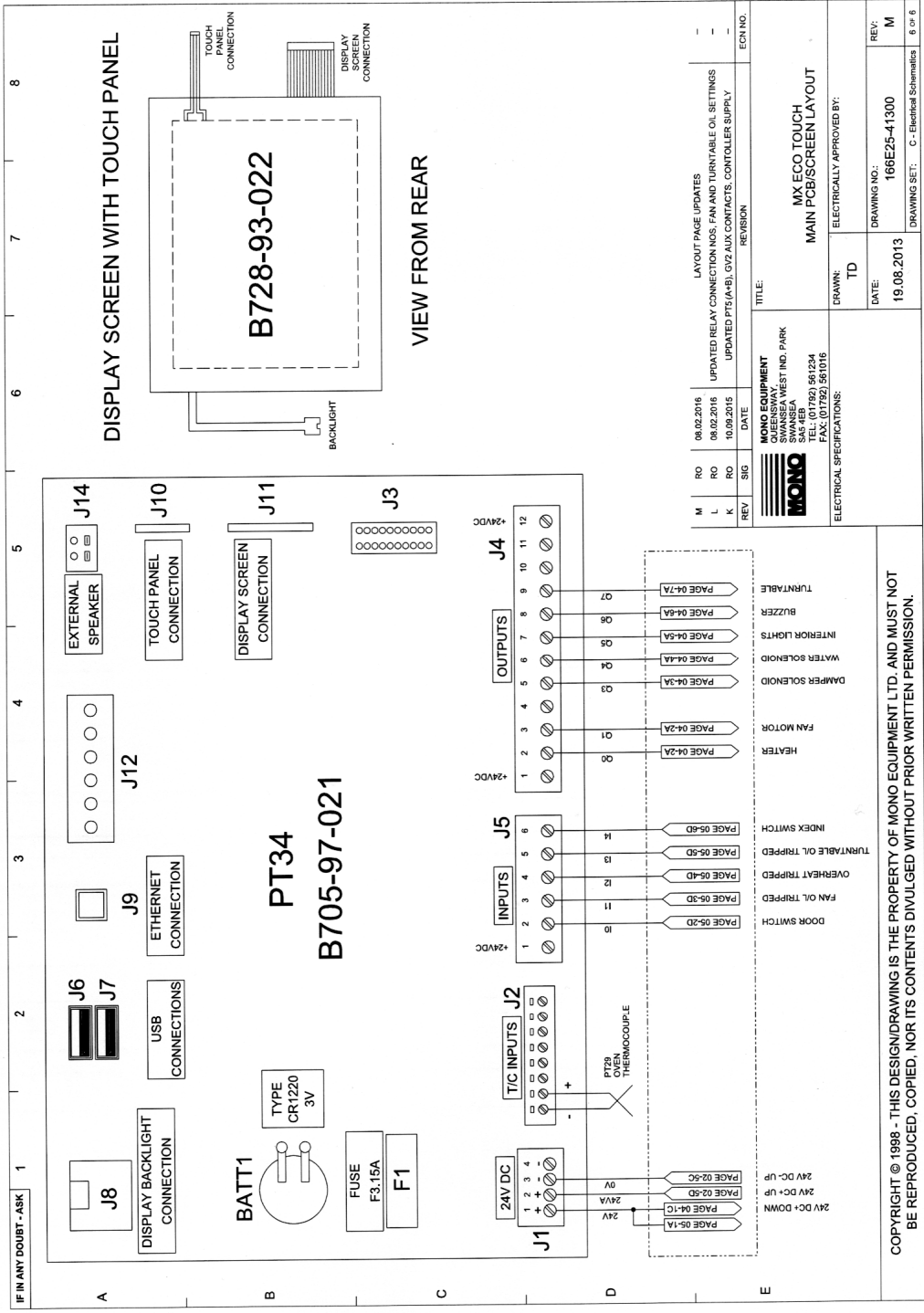

REV	SIG	DATE	DESCRIPTION	ECN NO.
M	RO	08.02.2016	LAYOUT PAGE UPDATES	-
L	RO	08.02.2016	UPDATED RELAY CONNECTION NOS: FAN AND TURNTABLE OIL SETTINGS	-
K	RO	10.09.2015	UPDATED PFS (A-B), GYZ AUX CONTACTS, CONTROLLER SUPPLY	-

MONO EQUIPMENT OUBERSWAY WEST IND. PARK SWANSEA SA5 4EP (01782) 561234 FAX: (01782) 561016		TITLE: MX ECO TOUCH MAIN PCB/SCREEN LAYOUT
ELECTRICAL SPECIFICATIONS: ELECTRICALLY APPROVED BY:		DRAWN: TD
DATE: 19.08.2013		DRAWING NO.: 166E25-41300
REV: M		DRAWING SET: C - Electrical Schematics
		REV: M
		REV: M

COPYRIGHT © 1998 - THIS DESIGN/DRAWING IS THE PROPERTY OF MONO EQUIPMENT LTD. AND MUST NOT BE REPRODUCED, COPIED, NOR ITS CONTENTS DIVULGED WITHOUT PRIOR WRITTEN PERMISSION.

MXT ECOTOUCH ELECTRIC OVEN - DEVICE LIST			
PART REFERENCE	DESCRIPTION		Mono Part Number
PT-1	Overheat Thermostat		8888-30-014
PT-2	Heating Element MCB		8872-22-074
PT-3	Heating Element MCB		8872-22-074
PT-4	Heating Element MCB		8872-22-074
PT-5	Heating Element Contactor		8801-08-032
PT-6	Main Fan Motor Auxiliary Contact		8801-14-006
PT-7	Turntable Motor Auxiliary Contact		8801-14-006
PT-10	Contact Control Circuit MCB		8872-22-001
PT-11	Control Circuit MCB		8872-22-062
PT-12	Pump Motor MCB		8872-22-062
PT-13	Interior Light Relay		8723-37-021
PT-14	Main Fan Motor Contactor		8801-08-031
PT-15	Main Fan Motor Starter (GV2)		8801-03-024
PT-16	Turntable Motor Contactor		8801-08-031
PT-17	Turntable Motor Starter (GV2)		8801-03-016
PT-18	24V DC Power Supply		8801-93-005
PT-19	Buzzer (Option)		8723-92-002
PT-24	Steam Solenoid		8965-83-007
PT-25	Damper Solenoid		8749-83-004
PT-26	Main Fan Motor		8912-74-035
PT-27	Turntable Motor Unit		8912-74-036
PT-28A	Turntable Index Switch Body		8801-11-013
PT-28B	Turntable Index Switch Head roller plunger		8801-45-008
PT-29	Thermocouple		8709-95-001
PT-30	Door Switch		8801-11-001
PT31	Led light assembly		166-13-00063
PT-34	PCB Assy		158-25-80000
PT-35	Heating Element		8979-04-001
PT36	VCCF4 80A Isolator		8801-07-002
PT-37	Heater Contactor Relay		8723-37-021
PT-38	USB Cable		8705-25-009
PT-39	Pump Relay (If Pump Fitted)		8723-37-021
PT-40	Suppressor Unit (If Pump Fitted)		8842-48-010
PT-41	Water Pump (If Fitted)		A900-28-005
PT-42	Speaker		8842-92-005

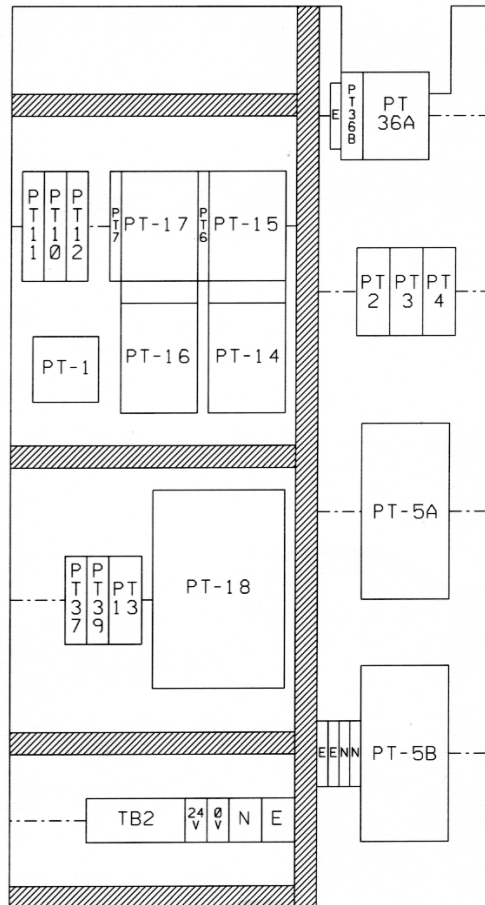



13.0 SPARES

SPARES ELECTRICAL

MXT ECOTOUCH ELECTRIC OVEN - DEVICE LIST		
PART REFERENCE	DESCRIPTION	Mono Part Number
PT-1	Overheat Thermostat	B888-30-014
PT-2	Heating Element MCB	B872-22-074
PT-3	Heating Element MCB	B872-22-074
PT-4	Heating Element MCB	B872-22-074
PT-5	Heating Element Contactor	B801-08-032
PT-6	Main Fan Motor Auxiliary Contact	B801-14-006
PT-7	Turntable Motor Auxiliary Contact	B801-14-006
PT-10	Contactor Control Circuit MCB	B872-22-001
PT-11	Control Circuit MCB	B872-22-062
PT-12	Pump Motor MCB	B872-22-062
PT-13	Interior Light Relay	B723-37-021
PT-14	Main Fan Motor Contactor	B801-08-031
PT-15	Main Fan Motor Starter (GV2)	B801-03-024
PT-16	Turntable Motor Contactor	B801-08-031
PT-17	Turntable Motor Starter (GV2)	B801-03-016
PT-18	24V DC Power Supply	B801-93-005
PT-19	Buzzer (Option)	B723-92-002
PT-24	Steam Solenoid	B965-83-007
PT-25	Damper Solenoid	B749-83-004
PT-26	Main Fan Motor	B912-74-035
PT-27	Turntable Motor Unit	B912-74-036
PT-28A	Turntable Index Switch Body	B801-11-013
PT-28B	Turntable Index Switch Head roller plunger	B801-45-008
PT-29	Thermocouple	B709-95-001
PT-30	Door Switch	B801-11-001
PT31	Led light assembly	166-13-00063
PT-34	PCB Assy	158-25-80000
PT-35	Heating Element	B979-04-001
PT36	VCCF4 80A Isolator	B801-07-002
PT-37	Heater Contactor Relay	B723-37-021
PT-38	USB Cable	B705-25-009
PT-39	Pump Relay (If Pump Fitted)	B723-37-021
PT-40	Suppressor Unit (If Pump Fitted)	B842-48-010
PT-41	Water Pump (If Fitted)	A900-28-005
PT-42	Speaker	B842-92-005

SPARES MECHANICAL

Fan drive "VEE" belt	A900-21-114
Door handle	160-32-02000
Bottom door seal	166-13-00060
Door glass unit	166-13-00035
"U" seal for glass unit	166-13-00055
Touch screen overlay	164-90-00001

PARTS LIST FOR OPTIONAL RACK TURNTABLE

(Factory-fitted to FG166-E****TT models only)

Figure 1: Parts list for rack turntable

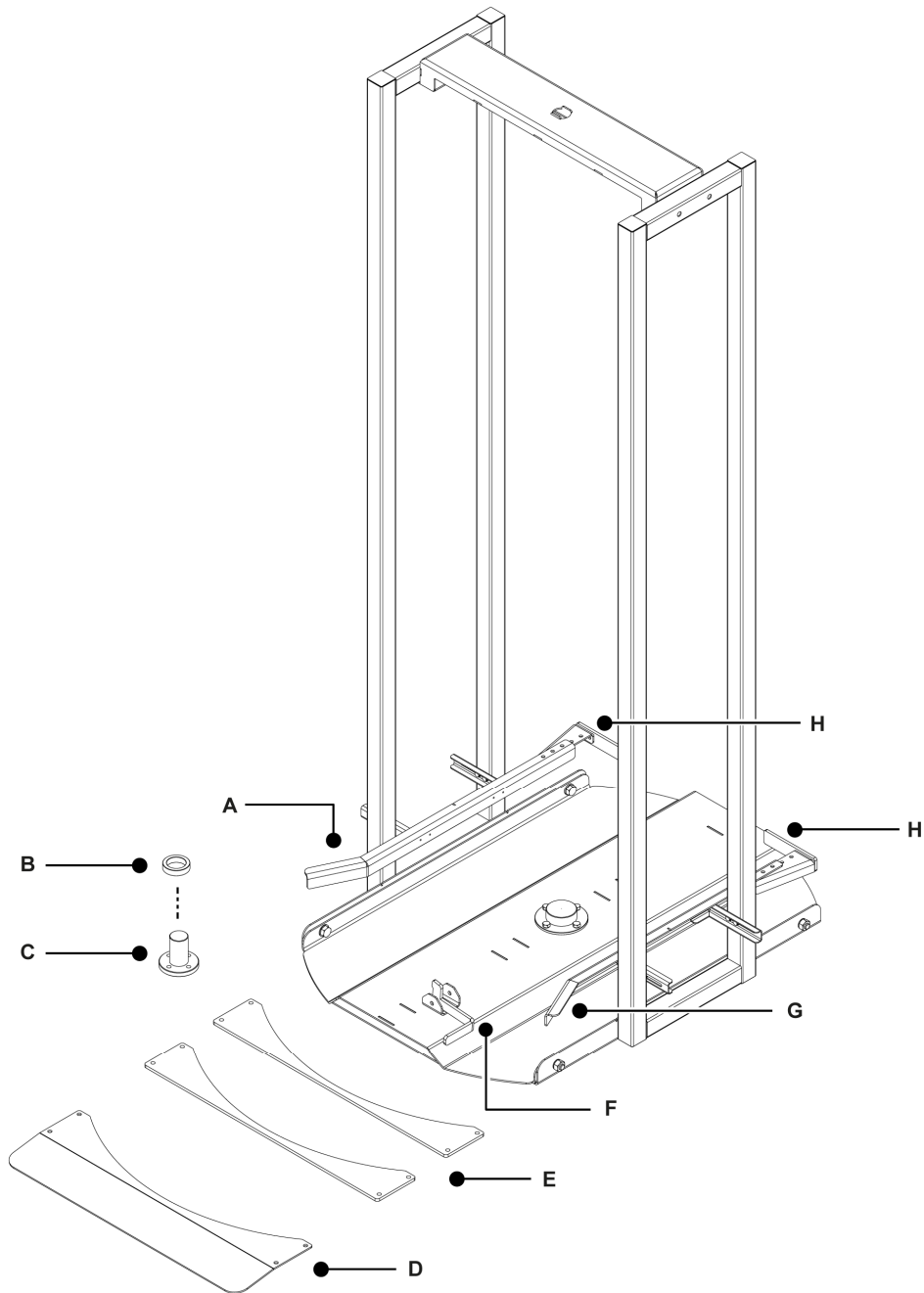

-
- | | |
|--|---|
| A. Left-hand adjustable side guide (166-17-00051) | E. Ramp packer (166-17-00021) |
| B. Base bearing (166-17-00014) | F. Foot brake (166-17-00065 or 166-17-00067)* |
| C. Floor turntable boss (166-17-00017) | G. Right-hand adjustable side guide (166-17-00053) |
| D. Turntable ramp (166-17-00019) | H. Back stop plate (166-17-00064) |
-

* Please state which rack type.

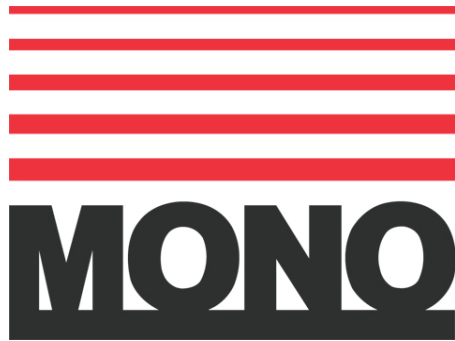

MONO

Queensway

Swansea West Industrial Estate

Swansea. SA5 4EB UK

email: spares@monoequip.com

Web site: www.monoequip.com

Tel. 01792 561234

Spares +44(0)1792 564039

Fax. 01792 561016